

# JAMMA FINGERBOARD TO HEADERS

WWW.ARCANIAC.COM

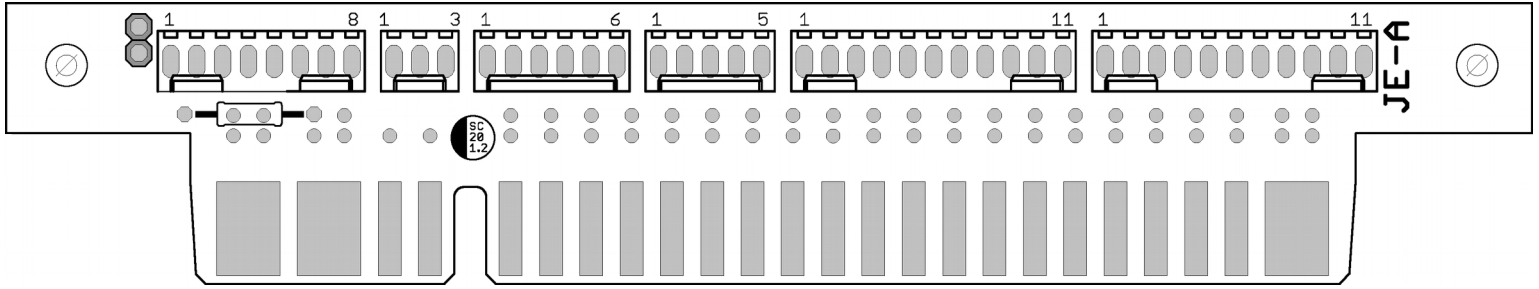

## Pinout.

CN1	
1	Ground
2	Ground
3	Ground
4	Ground
5	12 Volts
6	+5 Volts
7	+5 Volts
8	+5 Volts

CN2	
1	Speaker +
2	Ground
3	Speaker -

CN3	
1	+5 Volts
2	Ground
3	Video Red
4	Video Green
5	Video Blue
6	Video Sync

CN4	
1	Service switch
2	Test switch
3	Coin switch 1
4	Coin switch 2
5	Ground

CN5 / CN6	
1	Ground
2	Start
3	Up
4	Down
5	Left
6	Right
7	Button 1
8	Button 2
9	Button 3
10	Button 4
11	Button 5

Compatible with 2.54mm (.100") pitch headers.

The following JAMMA contacts are not routed out to a header connection:  
-5 Volts, Coin counter 1 / 2, Lock out coil 1 / 2, Tilt switch

A LED can be used to indicate power on.

## Dimensions.

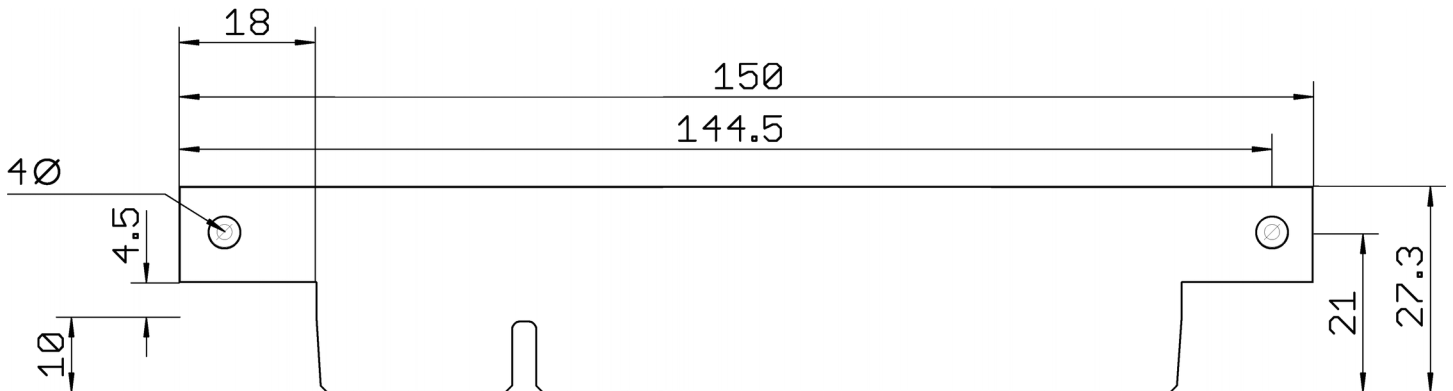

All Dimensions in Millimeters