

# JAMMA FINGERBOARD TO HEADERS

WWW.ARCANIAC.COM

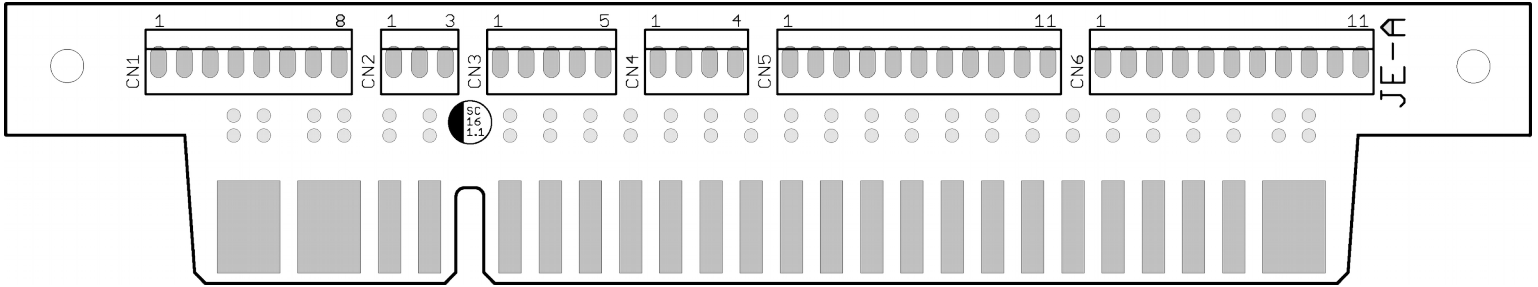

## Pinout.

CN1	CN2	CN3	CN4	CN5/CN6
1. Ground 2. Ground 3. Ground 4. Ground 5. 12 Volts 6. 5 Volts 7. 5 Volts 8. 5 Volts	1. Speaker + 2. Ground 3. Speaker -	1. Red 2. Green 3. Blue 4. Sync 5. Ground	1. Service switch 2. Test switch 3. Coin switch 1 4. Coin switch 2	1. Ground 2. Start 3. Up 4. Down 5. Left 6. Right 7. Button 1 8. Button 2 9. Button 3 10. Button 4 11. Button 5

Compatible with 2.54mm (.100") pitch headers.

The following JAMMA contacts are not routed out to a header connection:

- 5 Volts
- Coin counter 1/2
- Lock out coil 1/2
- Tilt switch

## Dimensions.

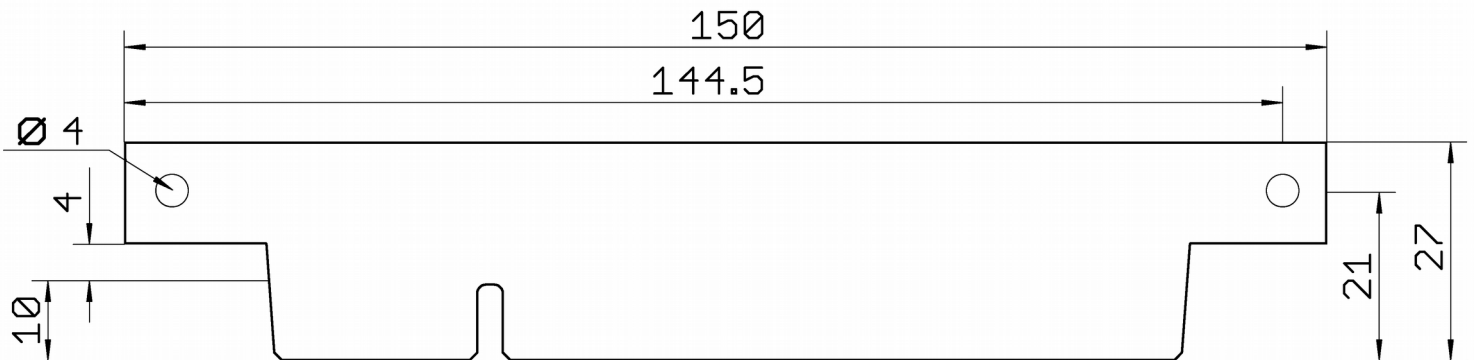

Dimensions in millimeters