

NUMBER C-176281



METRIC

ALL DIMENSIONS IN MM. DO NOT SCALE PRINT

PRINT DIST
REV. 10/83

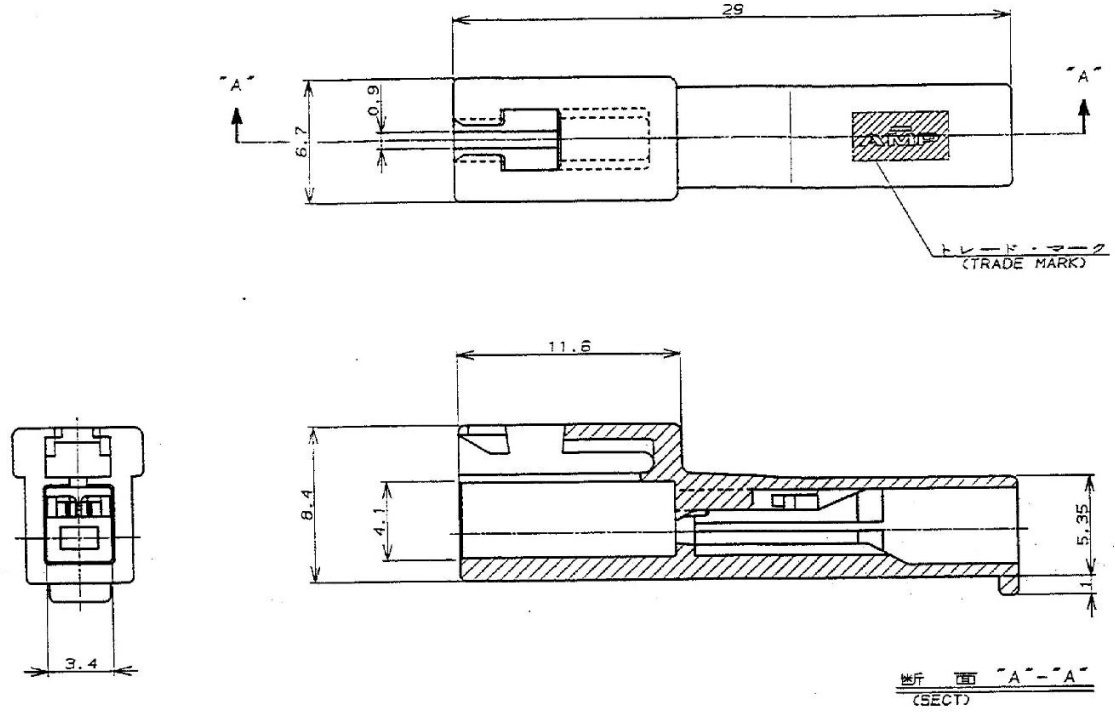

- 併:
1. 適用製品規格: 108-5302
 2. 適用コンタクト製番
タブ・コンタクト: 175150-□(※20-※16AWG)
175149-□(※26-※22AWG)
 3. 嵌合相手側製品製番
プラグ・ハウジング: 176270-□
リセ・コンタクト: 175152-□(※20-※16AWG)
175151-□(※26-※22AWG)
 4. 取扱説明書: 15-503J

5. APPLICATION SPEC.: 114-5142

- NOTES:
1. PRODUCT SPEC.: 108-5302
 2. APPLICABLE CONTACT P/N
TAB CONTACT: 175150-□(※20-※16AWG)
175149-□(※26-※22AWG)
 3. MATING CONN. P/N
PLUG HSG: 176270-□
REC CONTACT: 175152-□(※20-※16AWG)
175151-□(※26-※22AWG)
 4. INSTRUCTION SHEET: 15-503J

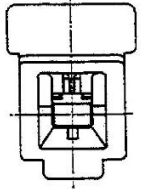

断面 "A-A"
(SECT)

黒 (BLACK)	↑	1	176281-9
青 (BLUE)	↑		-6
黄 (YELLOW)			-4
赤 (RED)	↓		-2
自然色 (NATURAL)		↑	176281-1
ハウジング色調 (HOUSING COLOR)	極数 (Pos.)		製番 (P/N)

				AMP 東京エレクトロニクス株式会社 Tokyo, Japan			
				品名 (NAME) AMPユニバーサル・パワー・コネクタ 1極 3.96mmピッチ キマツパ・ハウジング (1列タイプ) AMP UNIVERSAL POWER CONN. 3.96mm PITCH CAP HOUSING 1 Pos (SGL ROW)			
				一般公差 (GENERAL TOLERANCE)		SIZE LOC 製番 (No.)	
				100μm: ±0.2 100mm以下: ±0.25 300mm以下: ±0.3 角 度: ±3°		A3 J C-176281	
				尺度 (SCALE)		REV. B SHEET 1 OF 1	
				(CUSTOMER DRAWING)			

B	REVISED PER ECR-19-017823	M.G	D.Z	DATE	DR. M. Spidle 1/20/89	DE. M. Spidle 1/20/89
A1	ECR-19-017851	SM	DZ	DATE 11/2/89	DR. M. Spidle 1/20/89	DE. M. Spidle 1/20/89
A	数量 J-12715	MS	KC	DATE 11/2/89	DR. M. Spidle 1/20/89	DE. M. Spidle 1/20/89
O	作成 J-12204	MS	KC	DATE 11/2/89	DR. M. Spidle 1/20/89	DE. M. Spidle 1/20/89
LTR	変更 (REVISION RECORD)	DR	CHK	DATE	CHK. M. Spidle 1/20/89	APP. M. Spidle 1/20/89

THIS DRAWING IS UNPUBLISHED. RELEASED FOR PUBLICATION
 © COPYRIGHT ALL INTERNATIONAL RIGHTS RESERVED.

LOC	DIST	REVISIONS					
J	-	P	LTR	DESCRIPTION	DATE	DWN	APVD
		D6		REVISED PER ECR-19-017851	26NOV19	SM	DZ
		E			17DEC20	MG	DZ

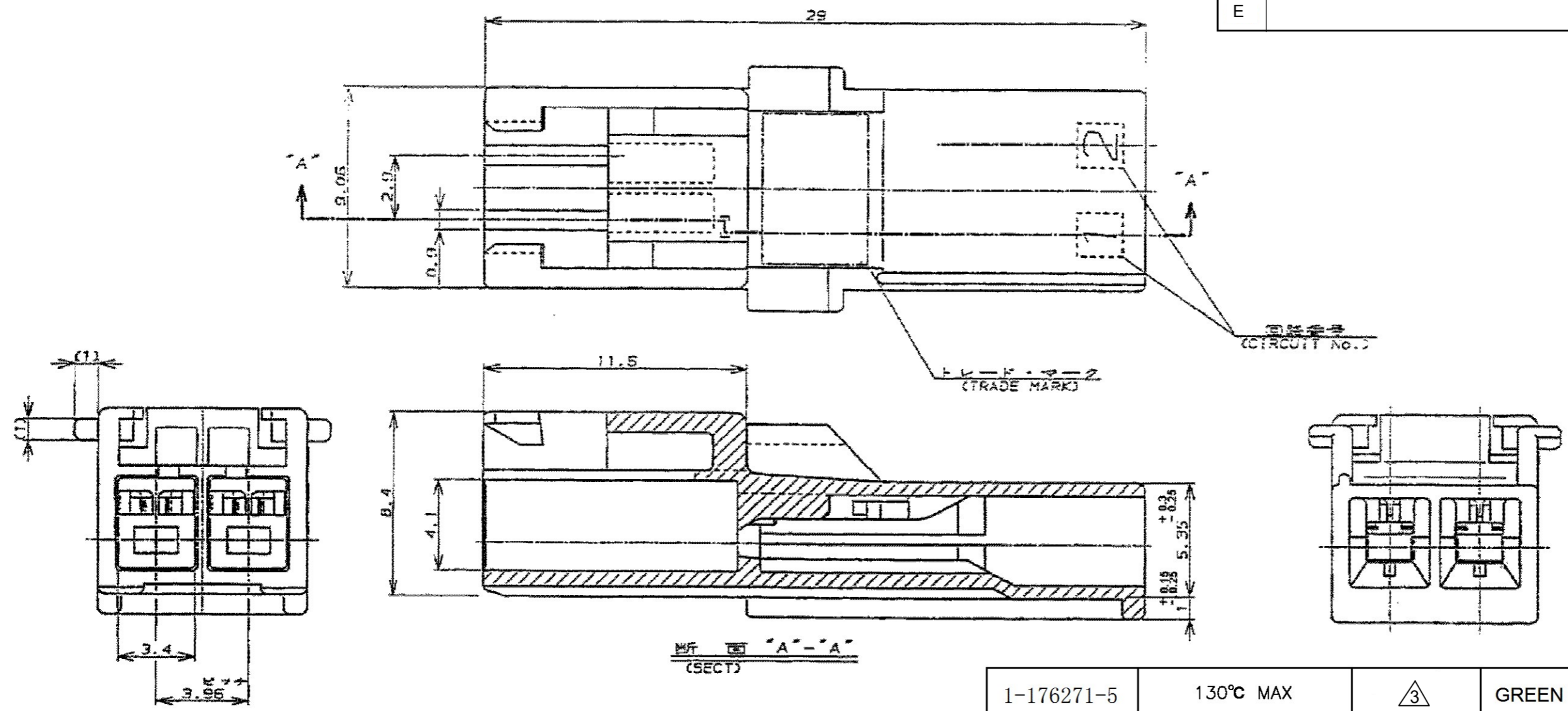

1. APPLICABLE CONTACT PART NUMBER;
 TAB CONTACT: 175150-□ (#20-#16AWG)
 175149-□ (#26-#22AWG)
 2 TO BE USED WITH THE CONTACT WHICH IS RATED 105°C MAX
 3 MATERIAL: PA66, UL94 V-0, GWIT 775°C

1-176271-5	130°C MAX	3	GREEN 绿	2	1-176282-5
1-176271-1	130°C MAX	3	NATURAL 自然色		1-176282-1 2
176271-□	105°C MAX	PA66	BLACK 黒	2	176282-9
			BLUE 青		176282-6
			YELLOW 黄		176282-4
			RED 赤		176282-2
	NATURAL 自然色			176282-1	
MATING CONN. PART NUMBER 嵌合相手型番	TEMPERATURE RATING 定格温度	TYPE 種類	HOUSING COLOR 色	Pos. 極数	PART NUMBER 型番

1. 適用端子型番;
 リセコンタクト: 175150-□ (#20-#16AWG)
 175149-□ (#26-#22AWG)
 2. 適用コンタクトの使用温度は最大105°C

THIS DRAWING IS A CONTROLLED DOCUMENT.

DWN Y.NARISAWA 19NOV1990	
CHK Y.FUJITA 19NOV1990	
APVD N.ONOUE 20NOV1990	
PRODUCT SPEC 108-5302	
APPLICATION SPEC 114-5142	AMP UNIVERSAL POWER CONN. 3.96mm PITCH CAP HOUSING 2 Pos. (SGL ROW) AMP ユニバーサルパワーコネクタ 2極 3.96mmピッチ キャップハウジング
MATERIAL SEE TABLE	SIZE A3 CAGE CODE 00779 DRAWING NO C-176282 RESTRICTED TO -
	RESTRICTED CUSTOMER SCALE NTS SHEET 1 OF 1 REV E

NUMBER C-176283
METRIC

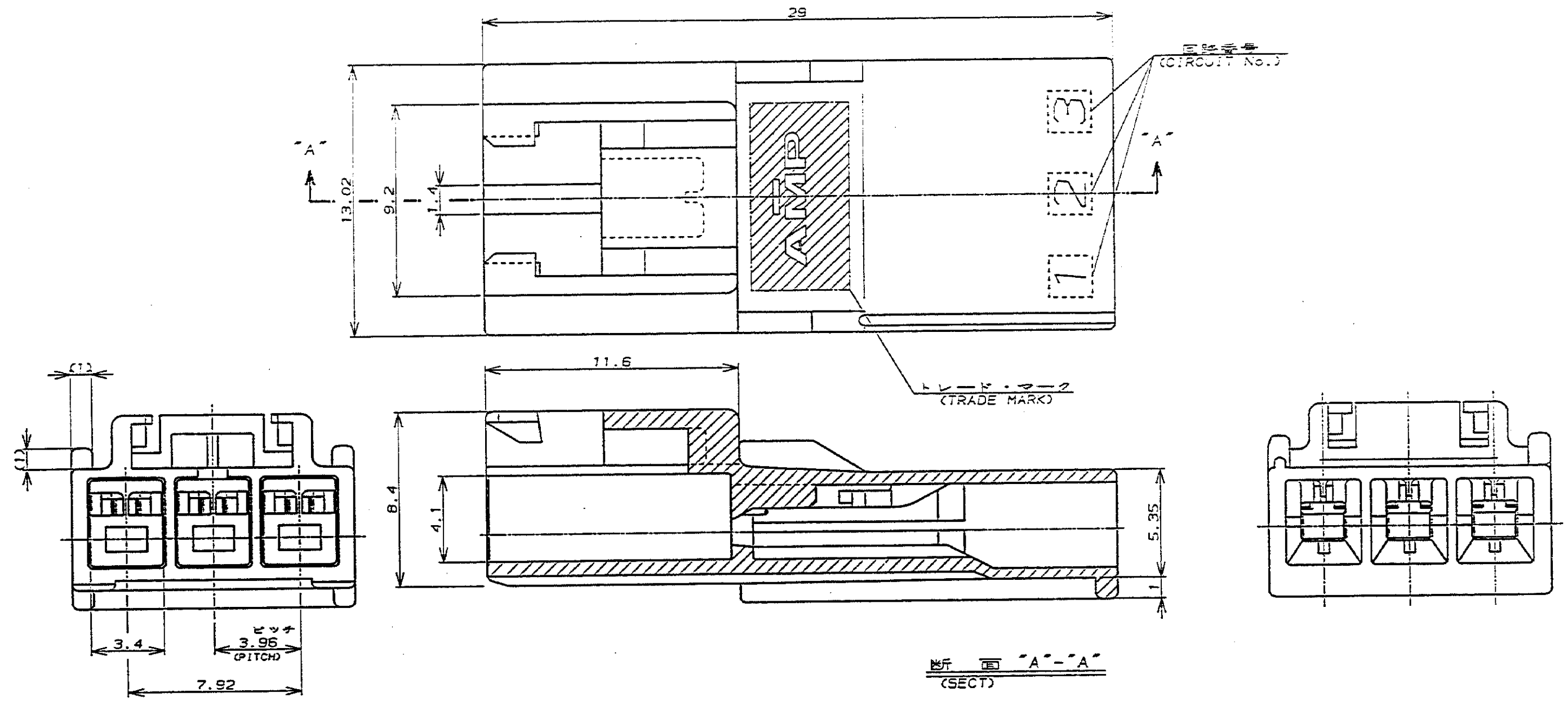

- 注:
- 適用製品規格: 108-5302
 - 適用コンタクト型番
タブ・コンタクト: 175150-[(*)20-*16AWG]
175149-[(*)26-*22AWG]
 - 適合相手側製品型番
プラグ・ハウジング: 176272-[(*)]
リセ・コンタクト: 175152-[(*)20-*16AWG]
175151-[(*)26-*22AWG]
 - 取扱説明書: IS-503J

黒 (BLACK)	3	176283-9
青 (BLUE)	↑	↑ -6
黄 (YELLOW)	↓	↓ -4
赤 (RED)	↓	↓ -2
自然色 (NATURAL)	3	176283-1
ハウジング色調 (HOUSING COLOR)	極数 (Pos.)	型番 (P/N)

- NOTES:
- PRODUCT SPEC, :108-5302
 - APPLICABLE CONTACT P/N
TAB CONTACT: 175150-[(*)20-*16AWG]
175149-[(*)26-*22AWG]
 - MATING CONN, P/N
PLUG HSG: 176272-[(*)]
REC CONTACT: 175152-[(*)20-*16AWG]
175151-[(*)26-*22AWG]
 - INSTRUCTION SHEET: IS-503J

© 19 BY AMP (Japan) LTD.

AMP Tokyo, Japan

名称 (NAME) AMPユニバーサルパワーコネクタ 3極
3.95mmピッチキャップ・ハウジング (1列タイプ)
AMP UNIVERSAL POWER CONN. 3.95mm PITCH CAP HOUSING 3 Pos (SGL ROW)

一般公差

100μT	±0.2
100μL	±0.25
100μW	±0.3
A	±3°

SIZE LOC 番号 (No.)
A3 J C-176283

尺度 (SCALED) REV. SHEET
C 1 OF 1

REVISED PER ECR-19-017623	M.G.	D.Z.	12 DEC 2020
改訂 J-12865	M.S.K.	1/90	
改訂 J-12153	Y.N.M.S.	1/89	
作成 J-12119	M.S.Y.F.	10/78	
		DR.	Y. NARISAWA 11/19
		DE.	M. Shide 1/19 90
		APP.	Shide 1/19 90

ALL DIMENSIONS IN MM. DO NOT SCALE PRINT

PRINT DIST

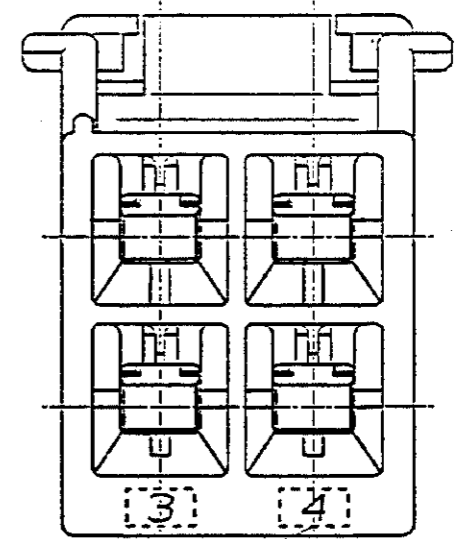
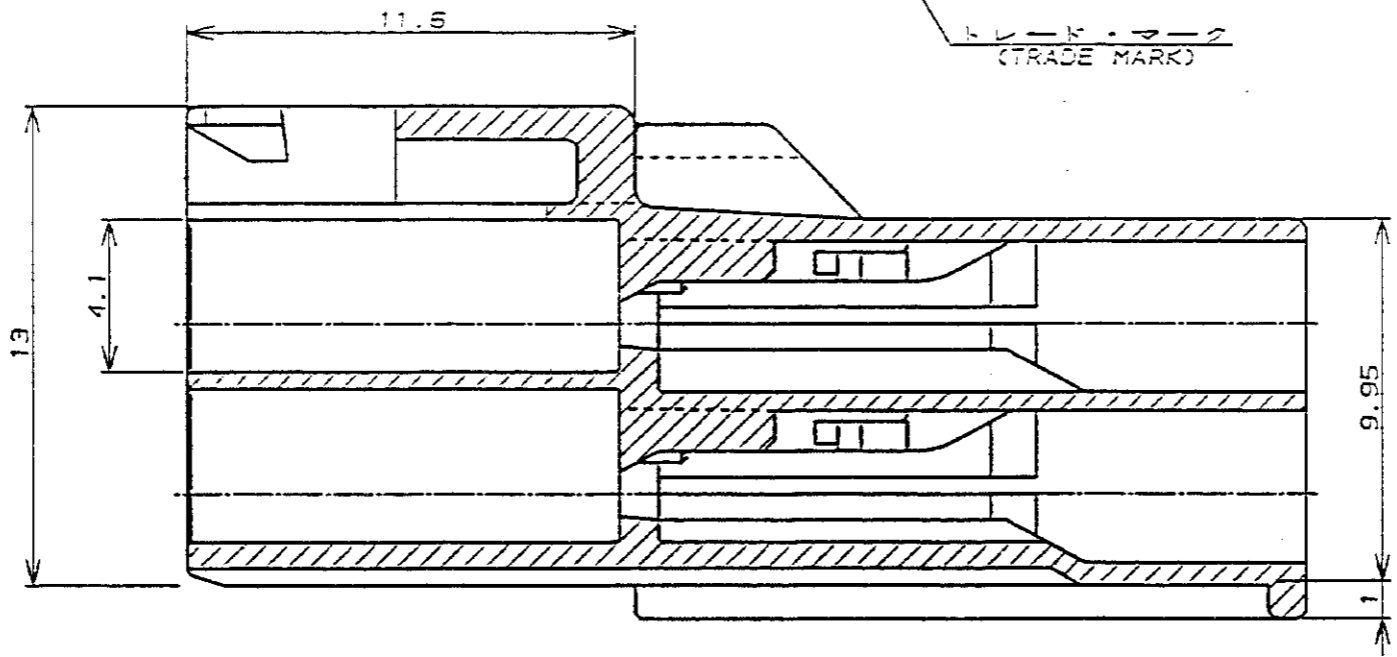
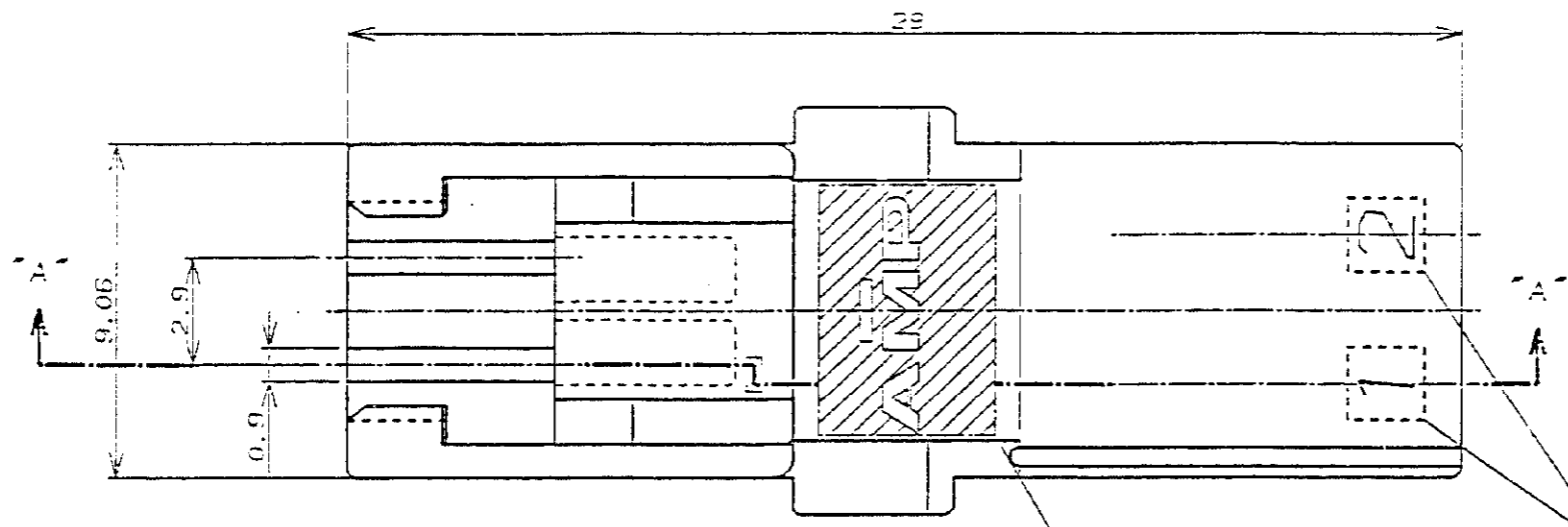
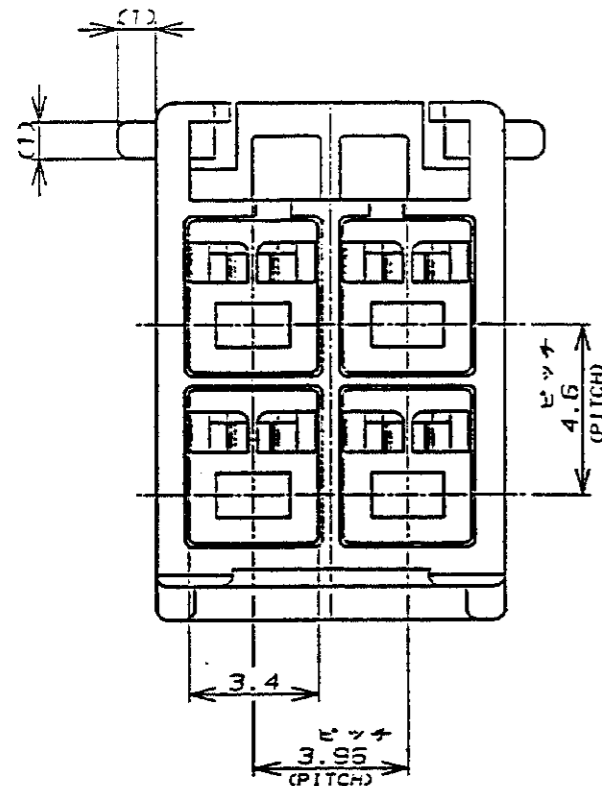

回路番号 (CIRCUIT No.)

トレード・マーク (TRADE MARK)

断面 "A"- "A" (SECT)

回路番号 (CIRCUIT No.)

NOTES:

- PRODUCT SPEC.: 108-5302
 TAB CONTACT: 175150-□ (φ20-φ16AWG)
 175149-□ (φ26-φ22AWG)
- MATING CONN. P/N
 PLUG HSG: 176273-□
 REC CONTACT: 175152-□ (φ20-φ16AWG)
 175151-□ (φ26-φ22AWG)
- INSTRUCTION SHEET: IS-503J

- 注:
- 適用製品規格: 108-5302
 - 適用コンタクト型番
 タブ・コンタクト: 175150-□ (φ20-φ16AWG)
 175149-□ (φ26-φ22AWG)
 - 嵌合相手側製品型番
 プラグ・ハウジング: 176273-□
 リセ・コンタクト: 175152-□ (φ20-φ16AWG)
 175151-□ (φ26-φ22AWG)
 - 取扱説明書: IS-503J

黒 (BLACK)	4	176284-9
青 (BLUE)	↑	↑ -6
黄 (YELLOW)	↓	↓ -4
赤 (RED)	↓	↓ -2
自然色 (NATURAL)	4	176284-1
ハウジング色別 (HOUSING COLOR)	極数 (Pos.)	型番 (P/N)

© 19 年 日本 株式会社 AMP (Japan) LTD.		AMP		東京 日本	
材料 (MATERIAL) S/S ナイロン (UL94V-0) S/S NYLON (UL94V-0)		仕上 (FINISH) ---		名称 (NAME) AMPユニバーサルパワーコネクタ 4極 3.95mmピッチキャップ・ハウジング (2列タイプ) AMP UNIVERSAL POWER CONN. 3.95mm PITCH CAP HOUSING 4 Pos (2SL ROW)	
DR. Y. NARISAWA 11/19 '90		DE. M. Shindo 1/19 '90		SIZE LOC 番号 (No.) A3 J C-176284	
LTR 変更 (REVISION RECORD)		DR CHK DATE		一般公差 10μL: ±0.2 100μL: ±0.25 300μL: ±0.3 角 度: ±3°	
CHK. Y. Shindo 1/19 '90		APP. J. Oono 1/19 '90		尺度 (SCALE) REV. B SHEET 1 OF 1	

NUMBER C-176285



METRIC

ALL DIMENSIONS IN MM. DO NOT SCALE PRINT

PRINT DIST

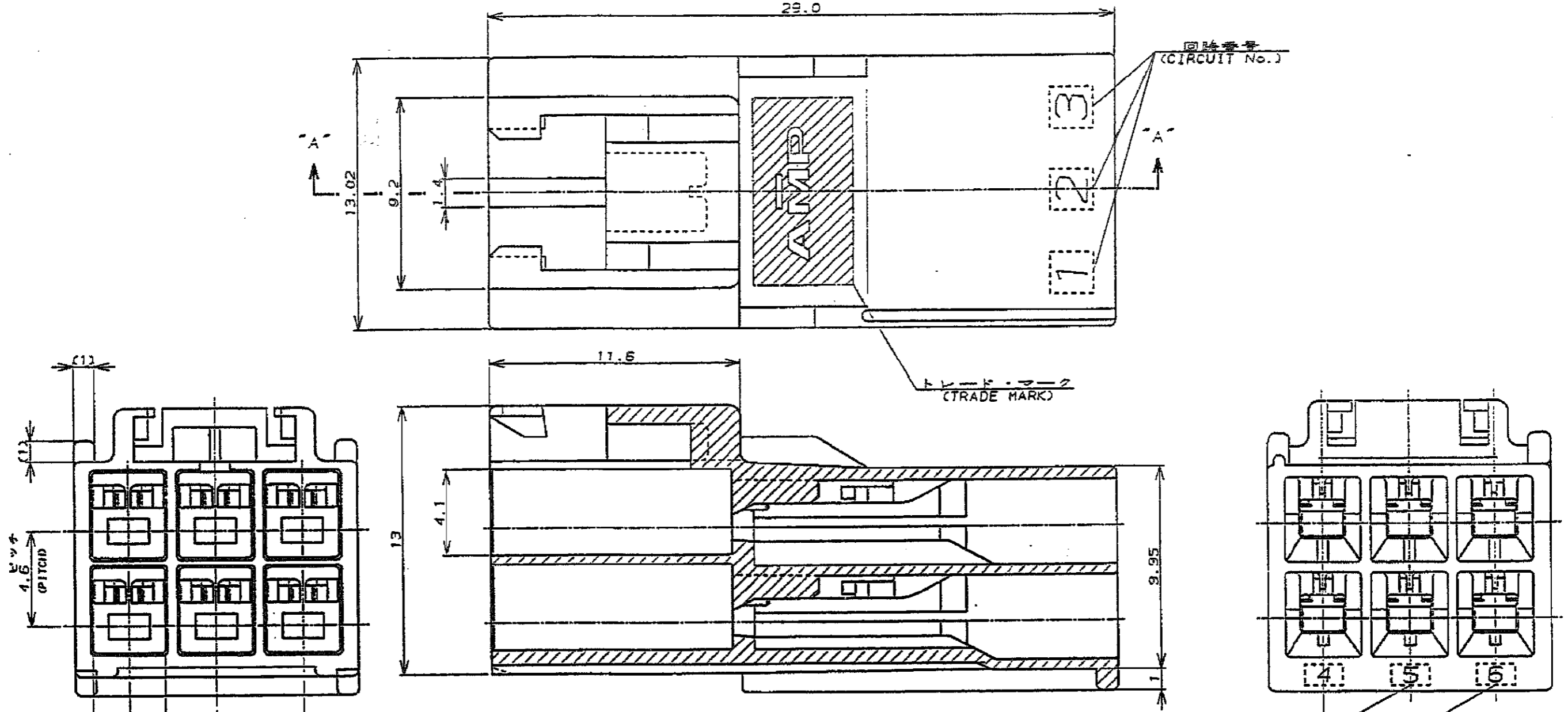

- 備:
1. 適用製品規格 : 108-5302
 2. 適用コンタクト型番
プラグ・コンタクト : 175150-□(φ20-φ16AWG)
175149-□(φ26-φ22AWG)
 3. 取替相手側製品型番
プラグ・ハウジング : 176274-□
リセ・コンタクト : 175152-□(φ20-φ16AWG)
175151-□(φ26-φ22AWG)
 4. 取扱説明書 : IS-503J

- NOTES:
1. PRODUCT SPEC. : 108-5302
 2. APPLICABEL CONTACT P/N
TAB CONTACT: 175150-□(φ20-φ16AWG)
175149-□(φ26-φ22AWG)
 3. MATING CONN, P/N
PLUG HSG: 176274-□
REC CONTACT: 175152-□(φ20-φ16AWG)
175151-□(φ26-φ22AWG)
 4. INSTRUCTION SHEET : IS-503J

断面 "A"- "A" (SECT)

5. APPLICATION SPEC: 114-5142

回路番号 (CIRCUIT No.)		色 (COLOR)	位置 (Pos.)	型番 (P/N)
①	黒 (BLACK)	6	↑	176285-9
	青 (BLUE)		↑	-6
	黄 (YELLOW)		↓	-4
	赤 (RED)		↓	-2
	自然色 (NATURAL)	6		176285-1
	ハウジング色調 (HOUSING COLOR)	極数 (Pos.)		型番 (P/N)

© 19 BY AMP (Japan) LTD.				Tyco Electronics AMP K.K. Kawasaki, Japan	
適合電線範囲 (WIRE RANGE) mm ² (AWG)		絶縁外皮径 (INSULATION DIA.) mm		名称 (NAME) AMPユニバーサルパワーコネクタ 6極 3.95mmピッチキャップ・ハウジング (2列タイプ) AMP UNIVERSAL POWER CONN. 3.95mm PITCH CAP HOUSING 6 Pos (2BL ROW)	
材料 (MATERIAL) S/S ナイロン (UL54V-0) S/S NYLON (UL54V-0)		仕上 (FINISH)		寸法 (DIMENSIONS) 102mm : φ0.2 108mm : φ0.25 208mm : φ0.3 φ : φ3°	
改訂 FJ00-0836-02 K.K. MS 4/15/02		改訂 EJ-12183 Y.N.MS 1/14/00		改訂 EJ-12119 M.S.Y.F 10/15/99	
DR. Y. NARISAWA 11/19		DE. M. Shide 1/19/00		APP. J. Otake 1/19/00	
LTR 改訂 (REVISION RECORD)		DR CHK DATE		SIZE LOC 符号 (No.) A3 J C-176285 尺度 (SCALE) REV. D SHEET 1 OF 1	

P	LTR	DESCRIPTION	DATE	DWN	APVD
	B	REVISED PER ECR-20-100642	19SEP2022	M.G	D.Z

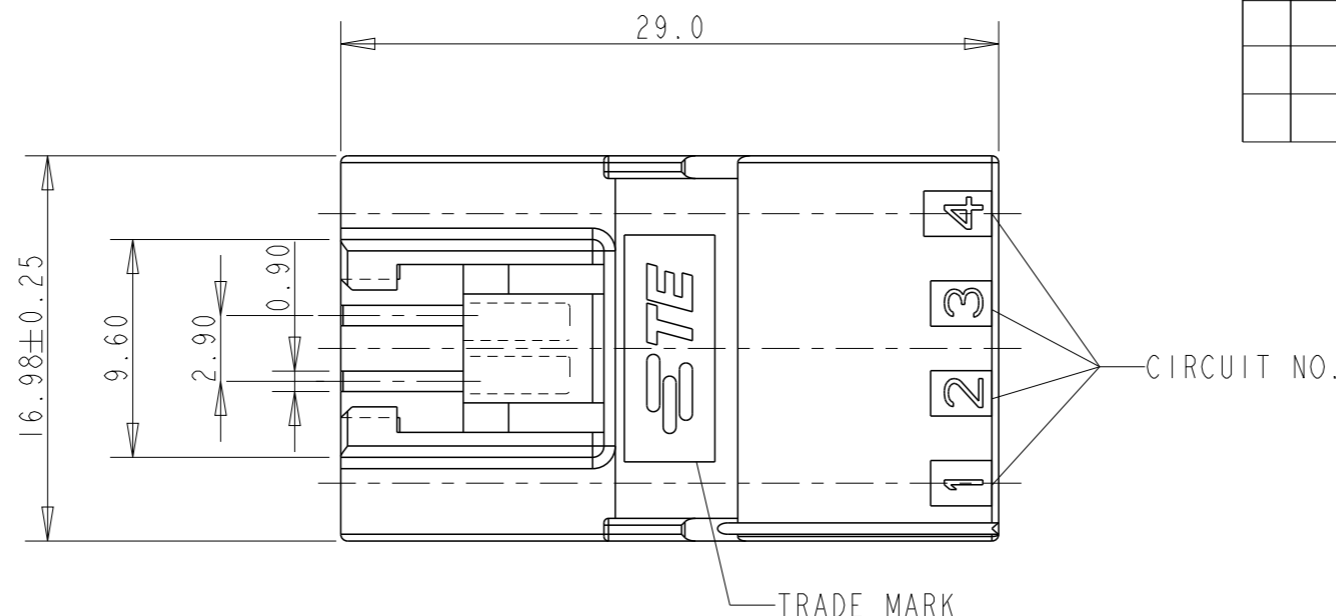

NOTES:

- APPLICABLE CONTACT P/N:
 TAB CONTACT: 175150-□ (20-16 AWG)
 175149-□ (26-22 AWG)
- MATING CONN. P/N:
 PLUG HSG: 176275-□
 REC CONTACT: 175152-□ (20-16 AWG)
 175151-□ (26-22 AWG)
- INSTRUCTION SHEET: IS-503J.

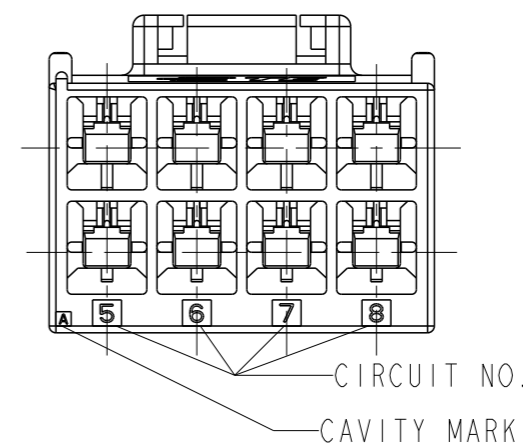
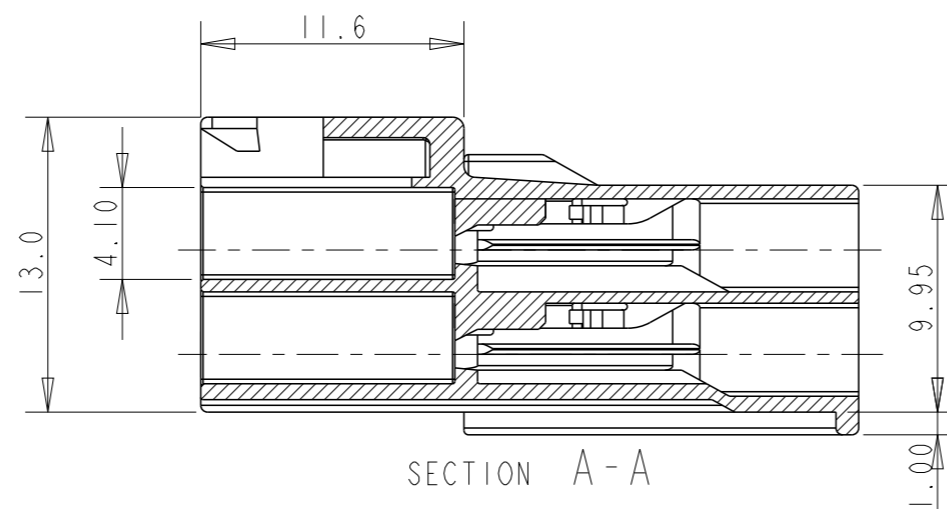
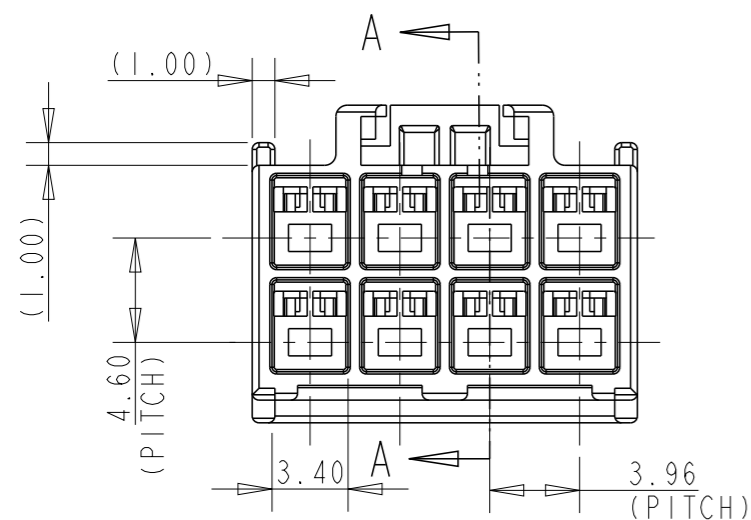

	BLACK	8	176286-9
DISCONTINUED	BLUE	8	176286-6
DISCONTINUED	YELLOW	8	176286-4
	RED	8	176286-2
	NATURAL	8	176286-1
HOUSING COLOR	POSITION	PART NUMBER	

THIS DRAWING IS A CONTROLLED DOCUMENT.		DWN M. SHINDO 23NOV1989	TE Connectivity	
DIMENSIONS: mm		CHK M. YOSHIDA 28NOV1989		
TOLERANCES UNLESS OTHERWISE SPECIFIED:		APVD N. ONOUE 28NOV1989	NAME CAP HOUSING, 3.96MM PITCH 8 POS AMP UNIVERSAL POWER CONN.	
0 PLC ± 1 PLC ±0.25 2 PLC ±0.20 3 PLC ± 4 PLC ± ANGLES ±3°		PRODUCT SPEC 108-5302	SIZE A3	
MATERIAL 6/6 NYLON (UL94 V-0)		APPLICATION SPEC 114-5142	CAGE CODE 00779	DRAWING NO C-176286
FINISH -		WEIGHT -	RESTRICTED TO -	
CUSTOMER DRAWING			SCALE 3:1	SHEET 1 OF 1
			REV B	

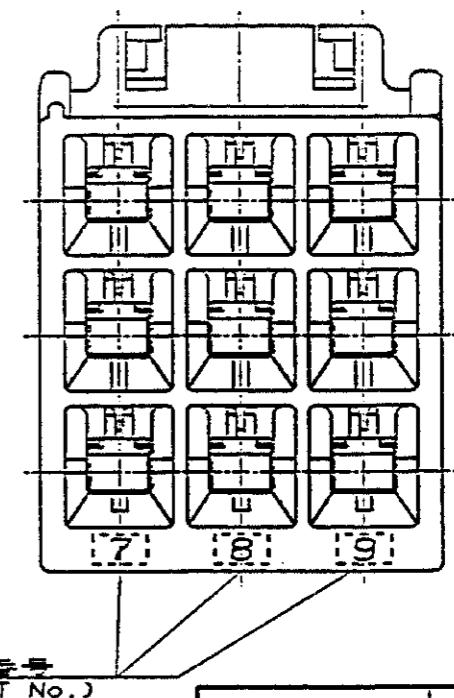
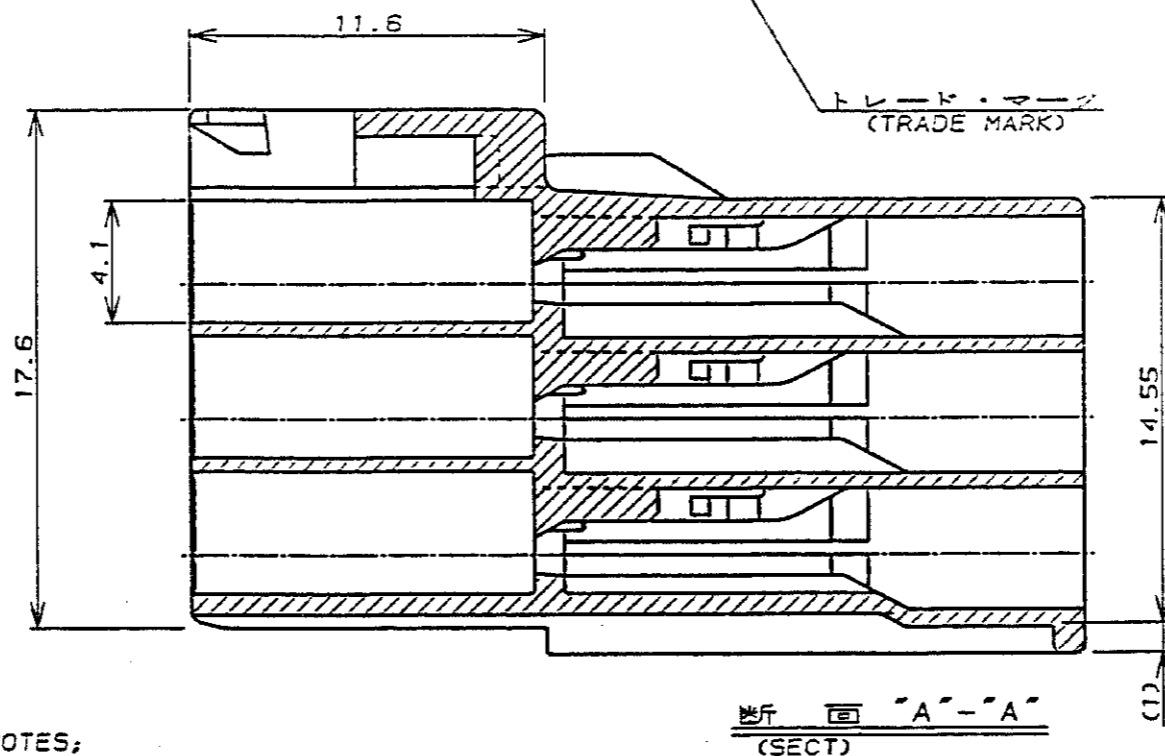
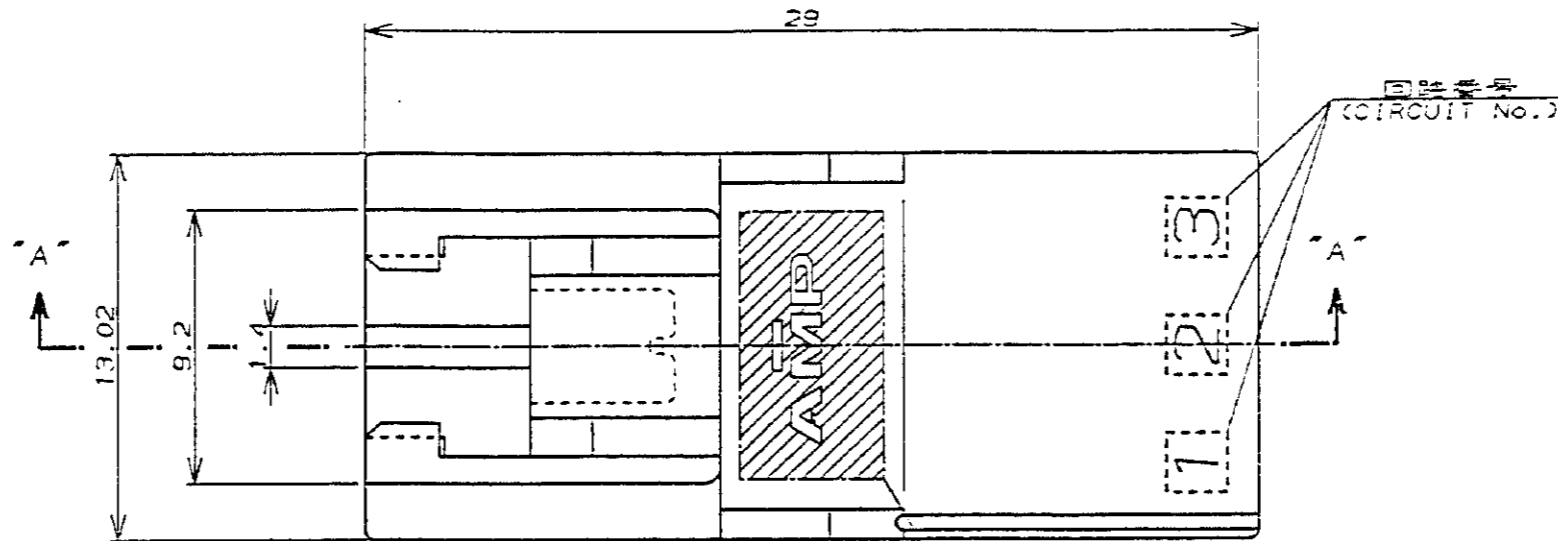
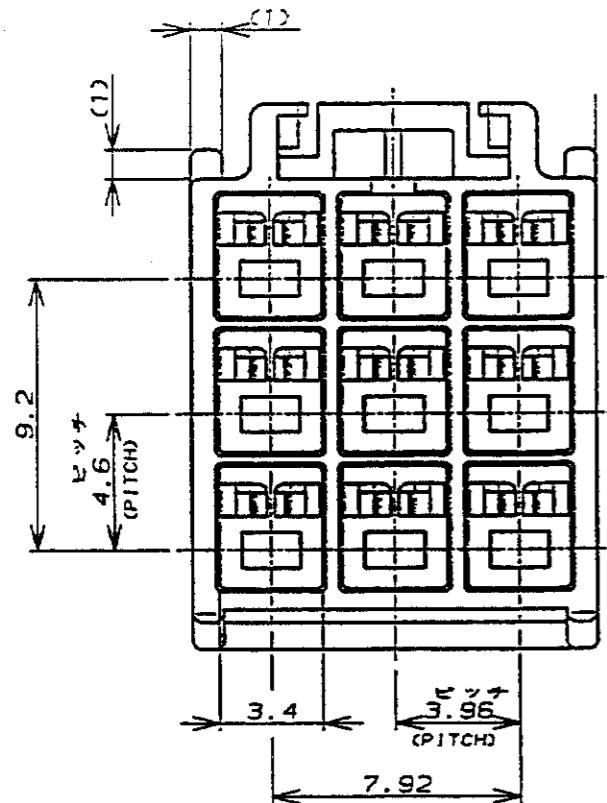

NOTES:

- PRODUCT SPEC.: 108-5302
- APPLICABLE CONTACT P/N
TAB CONTACT: 175150-□ (*20-#16AWG)
175149-□ (*26-#22AWG)
- MATING CONN, P/N
PLUG HSG: 176276-□
REC CONTACT: 175152-□ (*20-#16AWG)
175151-□ (*26-#22AWG)
- INSTRUCTION SHEET: IS-503J

注:

- 適用製品規格: 108-5302
- 適用コンタクト型番
タブ・コンタクト: 175150-□ (*20-#16AWG)
175149-□ (*26-#22AWG)
- 嵌合相手側製品型番
プラグ・ハウジング: 176276-□
リセ・コンタクト: 175152-□ (*20-#16AWG)
175151-□ (*26-#22AWG)
- 取扱説明書: IS-503J

黒 (BLACK)	9	176287-9
青 (BLUE)	↑	↑ -6
黄 (YELLOW)		-4
赤 (RED)	↓	↓ -2
自然色 (NATURAL)	9	176287-1
ハウジング色調 (HOUSING COLOR)	極数 (Pos.)	型番 (P/N)

© 18 BY AMP (Japan) LTD.		AMP 東京エレクトロニクス株式会社 Tokyo, Japan	
名称 (NAME) AMPユニバーサルパワーコネクタ 9極 3.96mmピッチ キャップ・ハウジング (3列タイプ) AMP UNIVERSAL POWER CONN. 3.96mm PITCH CAP HOUSING 9 Pos (TPL ROW)		一般公差	SIZE LOC 番号 (No.) A3 J C-176287
材料 (MATERIAL) S/6 ナイロン (UL94V-0) S/6 NYLON (UL94V-0)		仕上げ (FINISH)	10以下: ±0.2 10以上 30以下: ±0.25 30以上 100以下: ±0.3 100以上: ±0.5
DR. Y. NARISAWA 11/19 DE. M. Shide 1/9/90		尺度 (SCALE)	REV. B SHEET 1 OF 1
LTR 変更 (REVISION RECORD) DR CHK DATE		APP. J. Dume 1/9/90	

P	LTR	DESCRIPTION	DATE	DWN	APVD
	B	REVISED PER ECR-20-100642	19SEP2022	M.G	D.Z

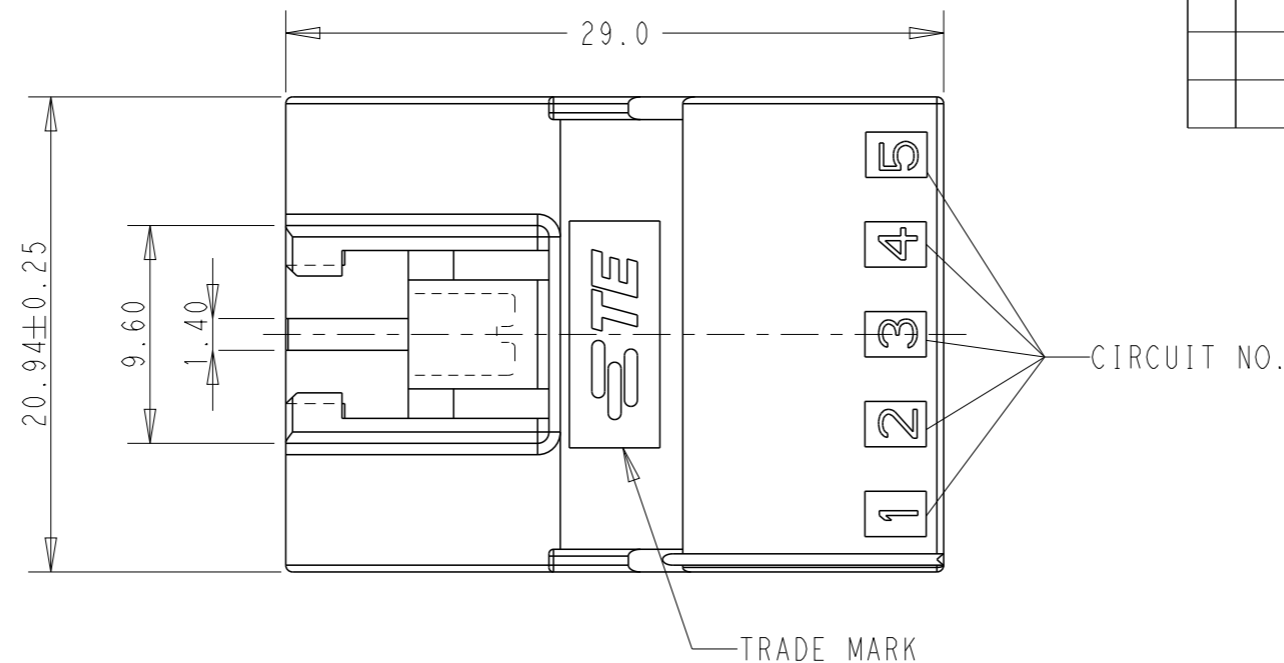

NOTES:

- APPLICABLE CONTACT P/N:
 TAB CONTACT: 175150-□ (20-16 AWG)
 175149-□ (26-22 AWG)
- MATING CONN. P/N:
 PLUG HSG: 176277-□
 REC CONTACT: 175152-□ (20-16 AWG)
 175151-□ (26-22 SWG)
- INSTRUCTION SHEET: IS-503J.

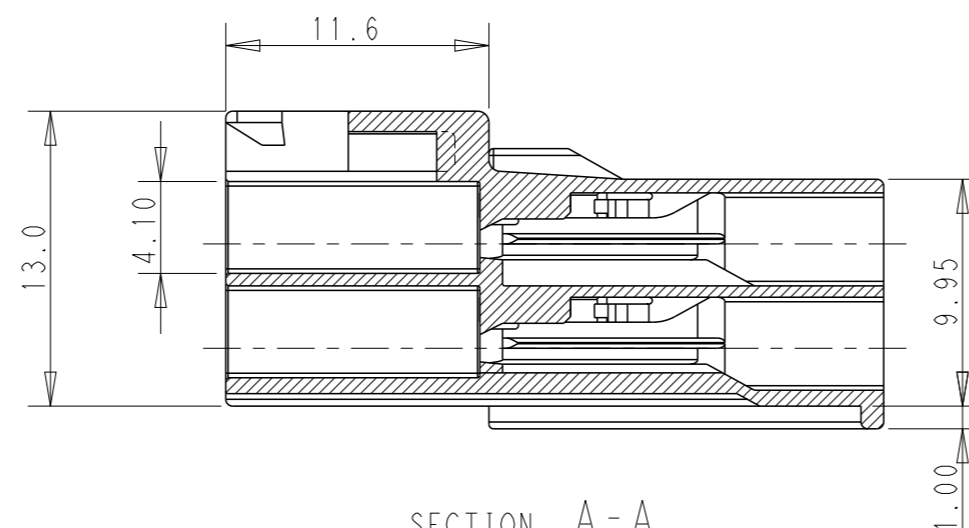
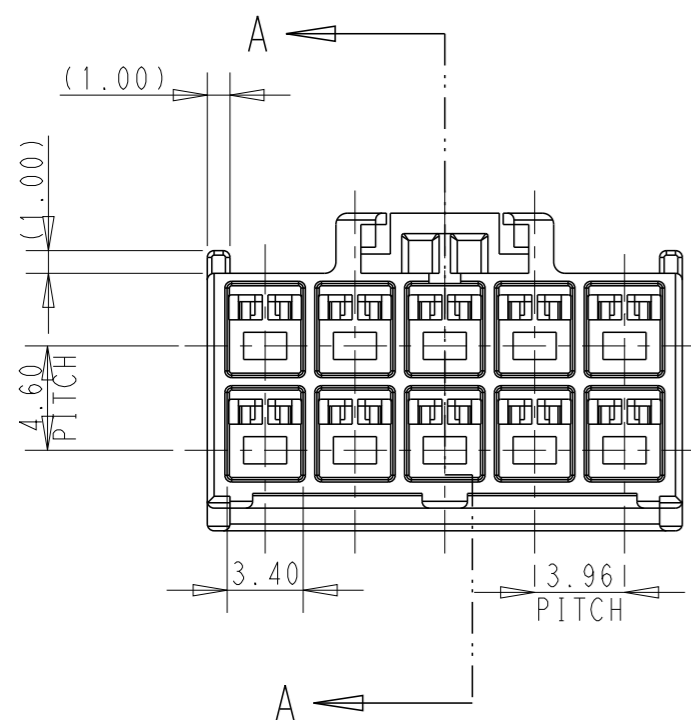

SECTION A-A

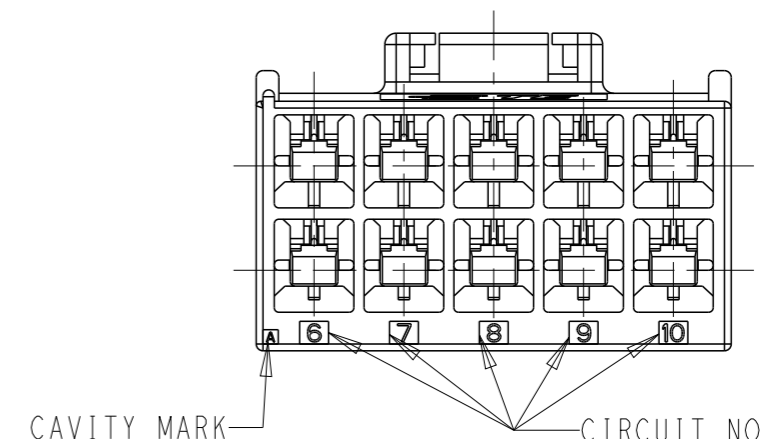

CAVITY MARK CIRCUI T NO.

DISCONTINUED	BLACK	10	176288-9
DEVELOPMENT	BLUE	10	176288-6
DISCONTINUED	YELLOW	10	176288-4
	RED	10	176288-2
	NATURAL	10	176288-1
HOUSING COLOR	POSITION	PART NUMBER	

THIS DRAWING IS A CONTROLLED DOCUMENT.		DWN M. SHINDO 23NOV1989	TE Connectivity	
DIMENSIONS: mm		CHK M. YOSHIDA 28NOV1989		
TOLERANCES UNLESS OTHERWISE SPECIFIED:		APVD N. ONOUE 28NOV1989	NAME AMP UNIVERSAL POWER CONN. 3.96MM PITCH CAP HOUSING 10 POS (DBL ROW)	
0 PLC ±- 1 PLC ±0.25 2 PLC ±0.20 3 PLC ±- 4 PLC ±- ANGLES ±3°		PRODUCT SPEC 108-5302	SIZE A3	
MATERIAL 6/6 NYLON (UL94 V-0)		APPLICATION SPEC 114-5142	CAGE CODE 00779	DRAWING NO C=176288
FINISH -		WEIGHT -	RESTRICTED TO -	
CUSTOMER DRAWING			SCALE 3:1	SHEET 1 OF 1
			REV B	

REVISIONS					
P	LTR	DESCRIPTION	DATE	DWN	APVD
B		REVISED PER ECR-20-100642	19SEP2022	M.G	D.Z

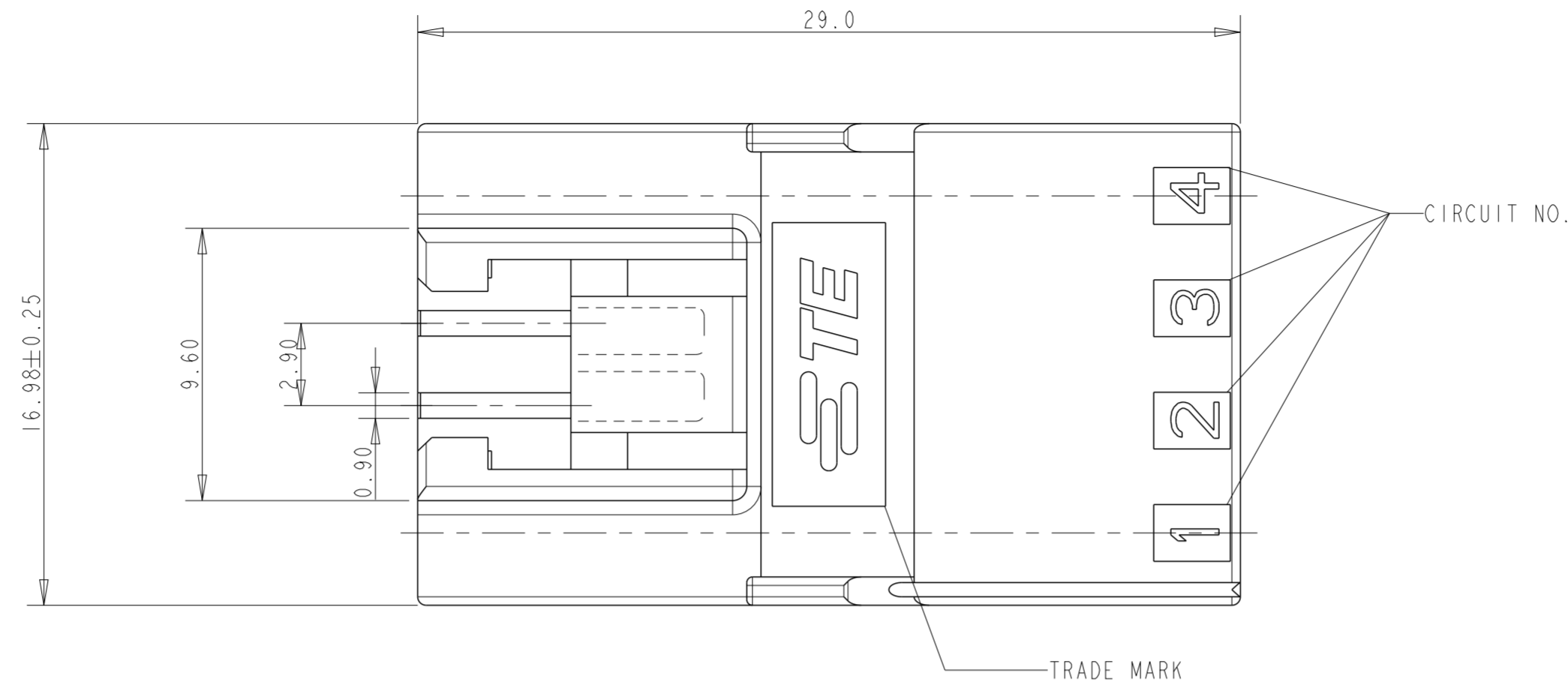

NOTES:

- APPLICABLE CONTACT P/N:
 TAB CONTACT: 175150- (20-16 AWG)
 175149- (26-22 AWG)
- MATING CONN. P/N:
 PLUG HSG: 176278-
 REC HSG: 175152- (20-16 AWG)
 175151- (26-22 AWG)
- INSTRUCTION SHEET: IS-503J.

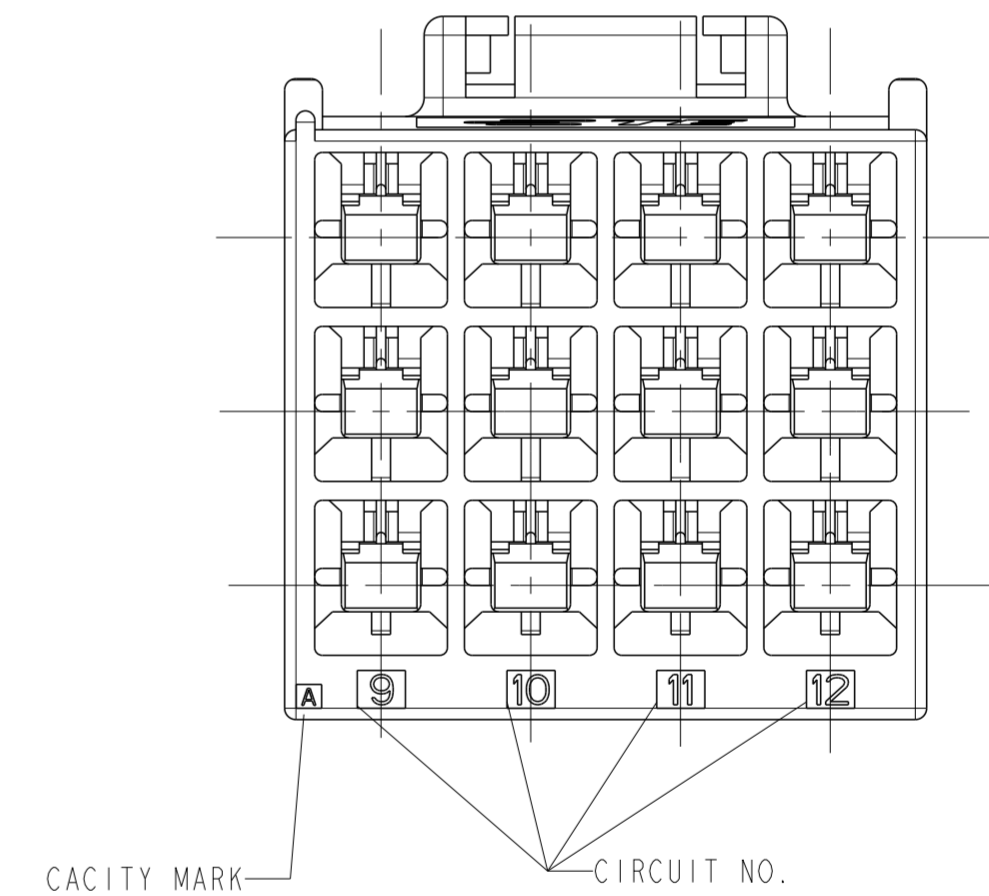
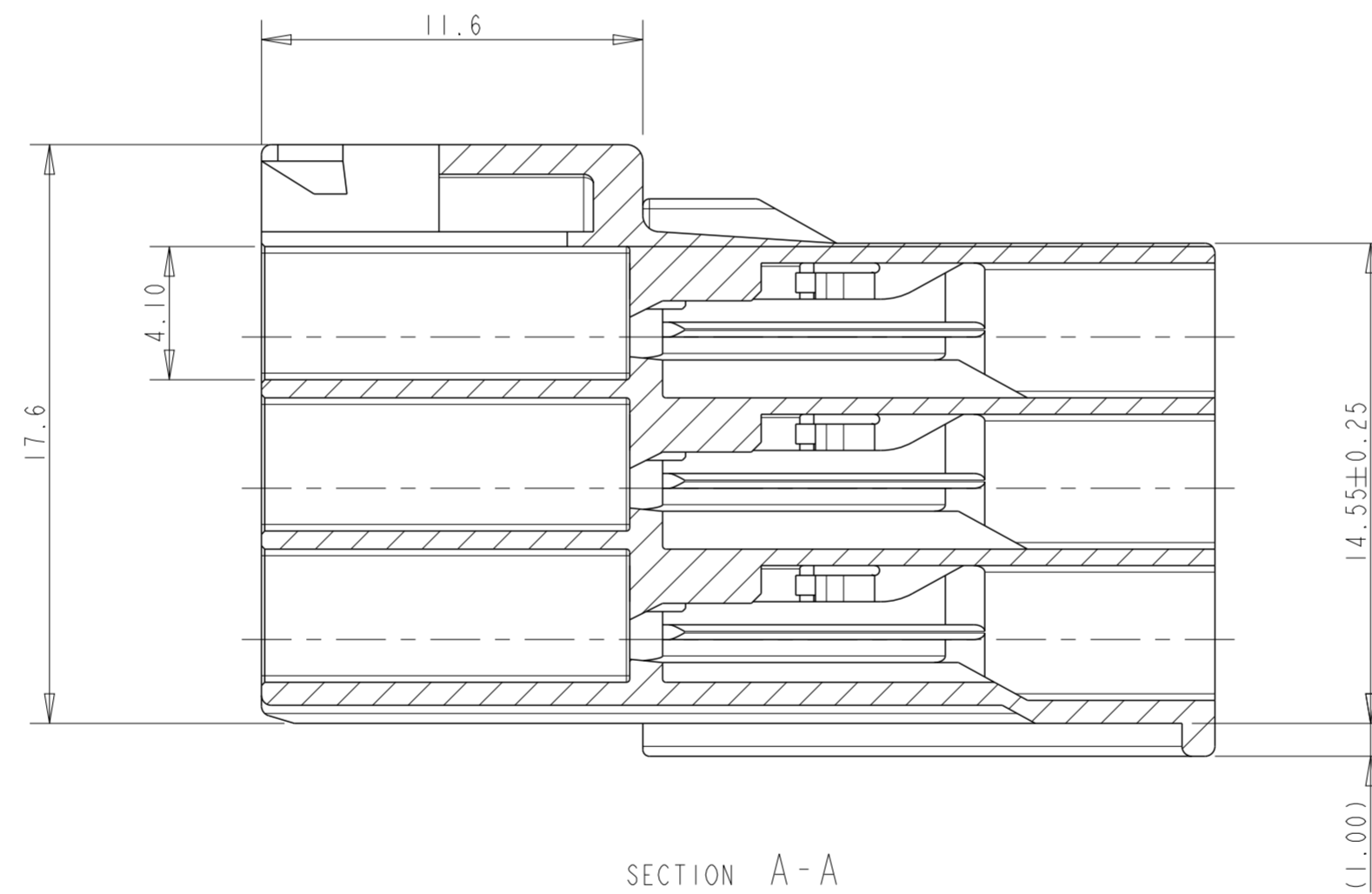
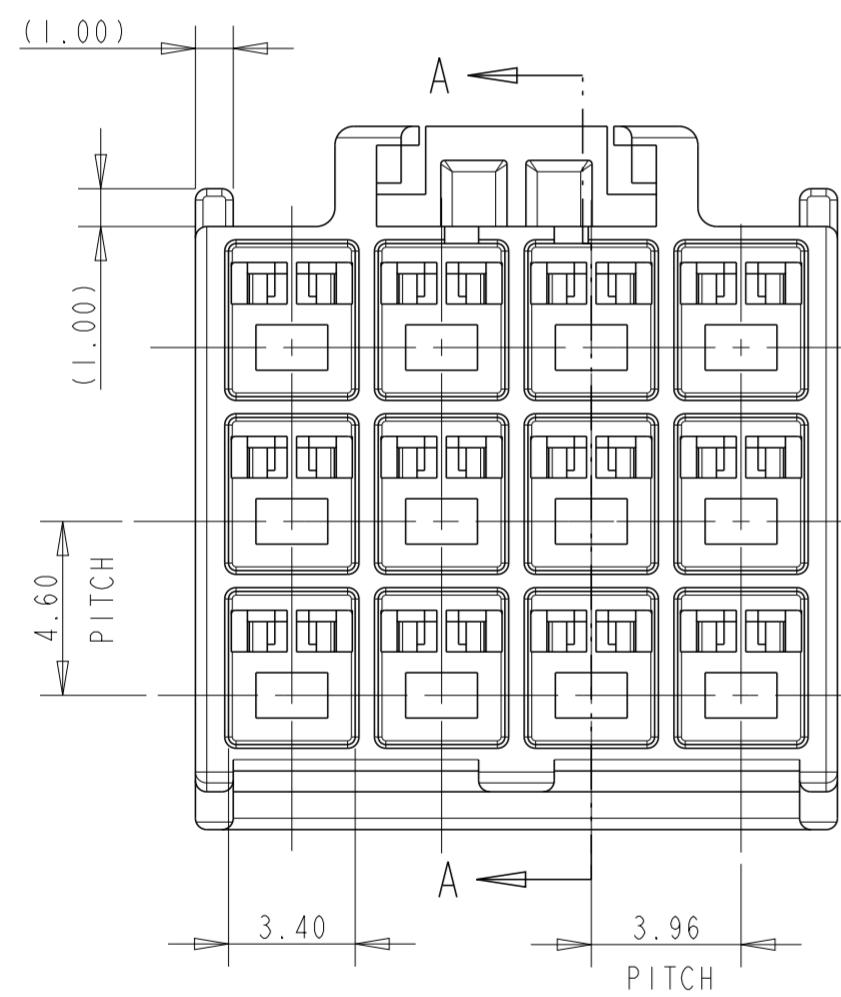

DEVELOPMENT	DISCONTINUED	DISCONTINUED	DISCONTINUED	HOUSING COLOR	POSITION	PART NUMBER
				BLACK	12	176289-9
				BLUE	12	176289-6
				YELLOW	12	176289-4
				RED	12	176289-2
				NATURAL	12	176289-1

THIS DRAWING IS A CONTROLLED DOCUMENT.		DWN M. SHINDO 23NOV1989	TE Connectivity															
DIMENSIONS: mm		CHK M. YOSHIDA 28NOV1989																
TOLERANCES UNLESS OTHERWISE SPECIFIED:		APVD N. ONQUE 28NOV1989	NAME AMP UNIVERSAL POWER CONN, 3.96mm PITCH CAP HOUSING 12 POS (TPL ROW)															
<table border="1"> <tr> <td>0 PLC</td> <td>±</td> </tr> <tr> <td>1 PLC</td> <td>±0.25</td> </tr> <tr> <td>2 PLC</td> <td>±0.2</td> </tr> <tr> <td>3 PLC</td> <td>±</td> </tr> <tr> <td>4 PLC</td> <td>±</td> </tr> <tr> <td>ANGLES</td> <td>±3°</td> </tr> <tr> <td>FINISH</td> <td>-</td> </tr> </table>		0 PLC	±	1 PLC	±0.25	2 PLC	±0.2	3 PLC	±	4 PLC	±	ANGLES	±3°	FINISH	-	PRODUCT SPEC 108-5302	SIZE A2	
0 PLC	±																	
1 PLC	±0.25																	
2 PLC	±0.2																	
3 PLC	±																	
4 PLC	±																	
ANGLES	±3°																	
FINISH	-																	
MATERIAL 6/6 NYLON (UL94 V-0)		APPLICATION SPEC 114-5142	CAGE CODE 00779	DRAWING NO C-176289														
		WEIGHT -	RESTRICTED TO -															
		CUSTOMER DRAWING	SCALE 5:1	SHEET 1 OF 1														
			REV B															

REVISIONS					
P	LTR	DESCRIPTION	DATE	DWN	APVD
B		REVISED PER ECR-20-100642	19SEP2022	M.G	D.Z

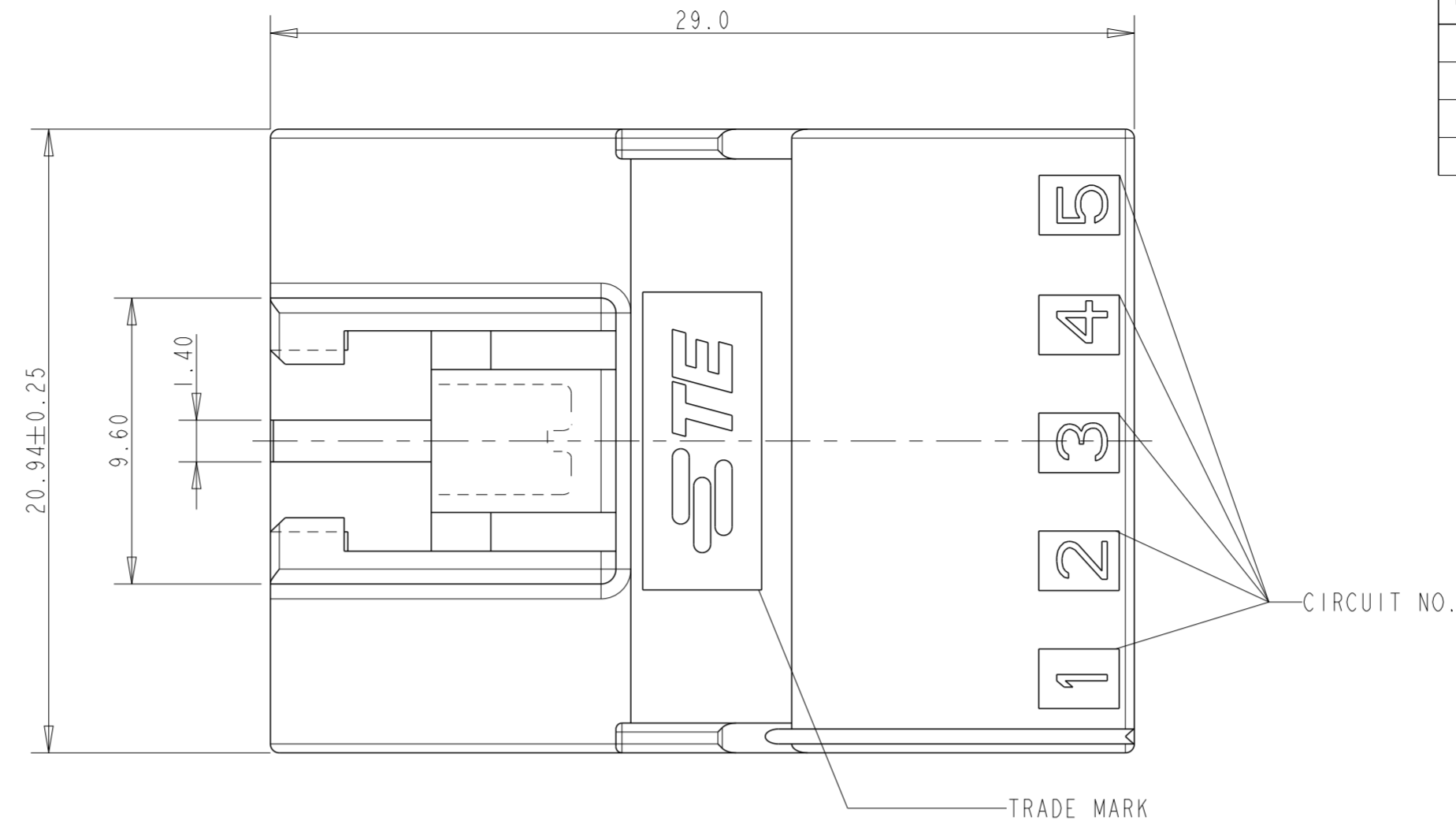

- NOTES:
- APPLICABLE CONTACT P/N:
 TAB CONTACT: 175150- (20-16 AWG)
 175149- (26-22 AWG)
 - MATING CONN. P/N:
 PLUG HSG: 176279-
 REC HSG: 175152- (20-16 AWG)
 175151- (26-22 AWG)
 - INSTRUCTION SHEET: IS-503J.

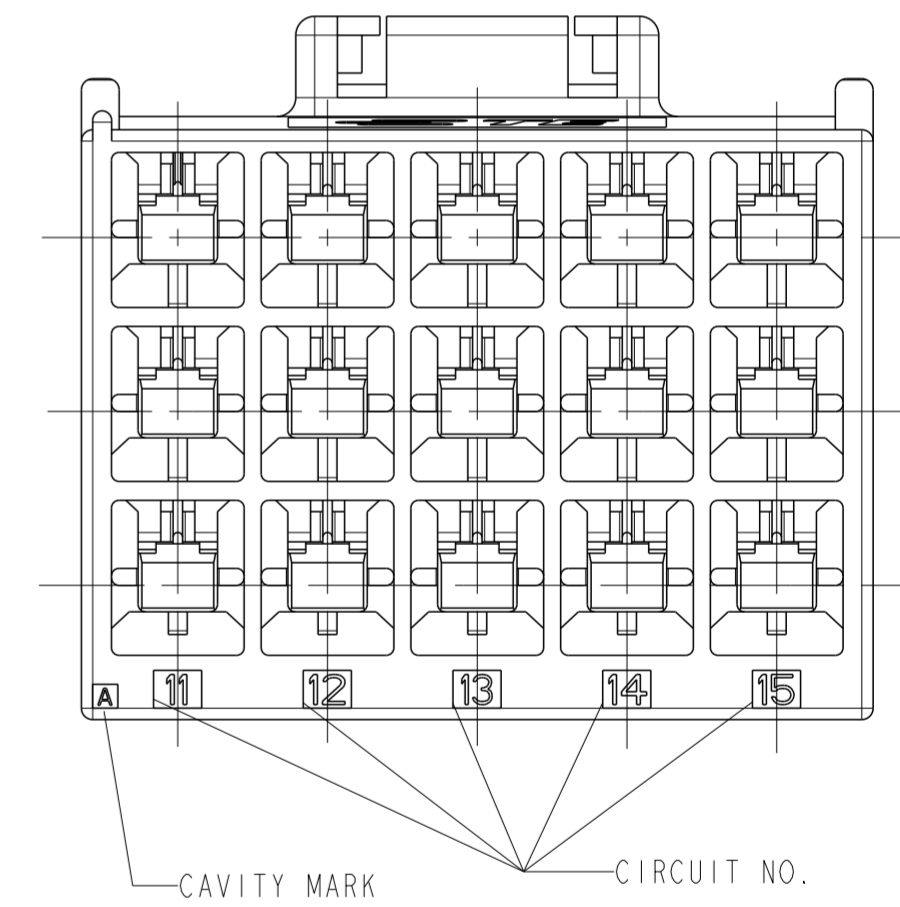
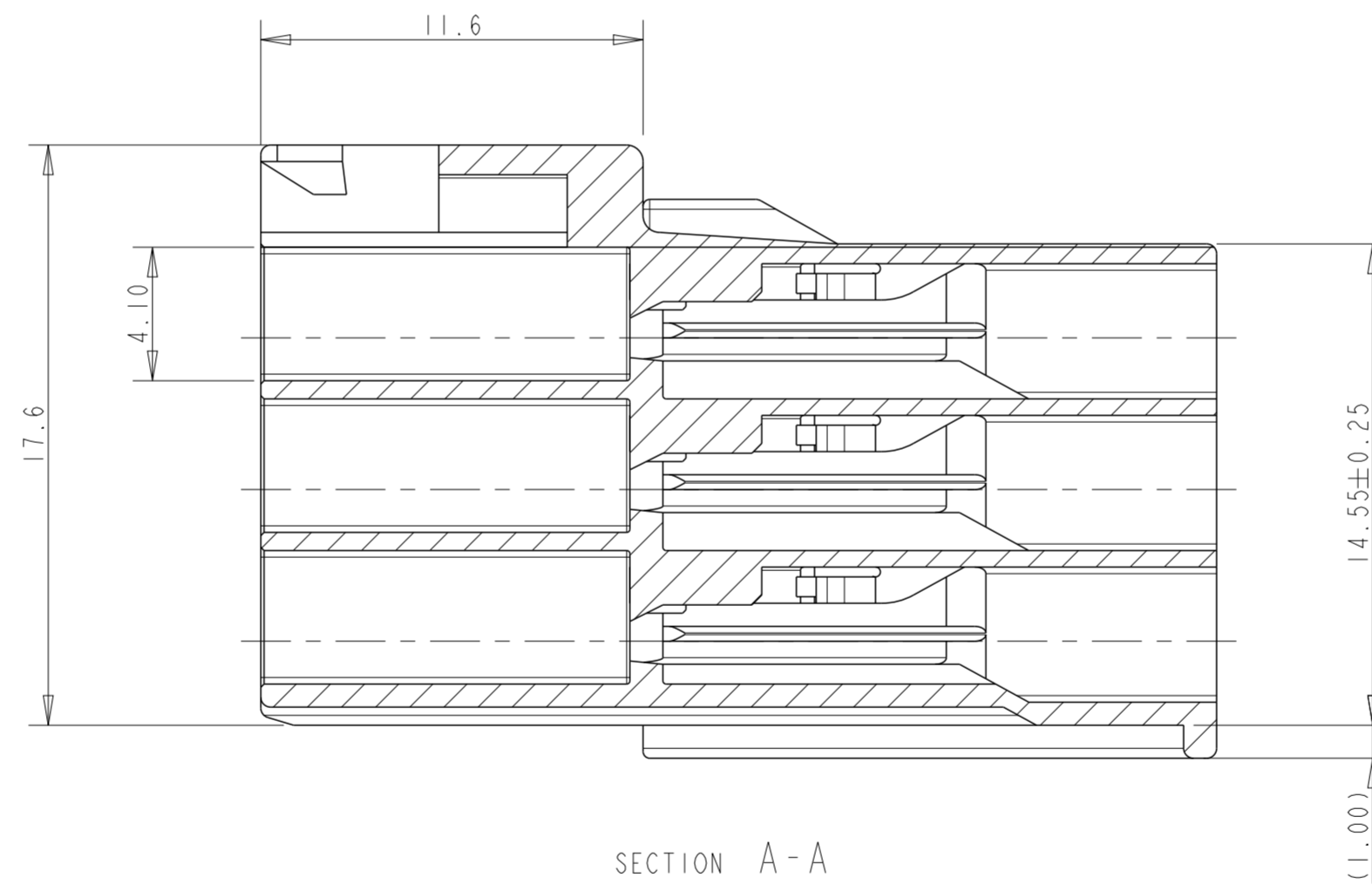
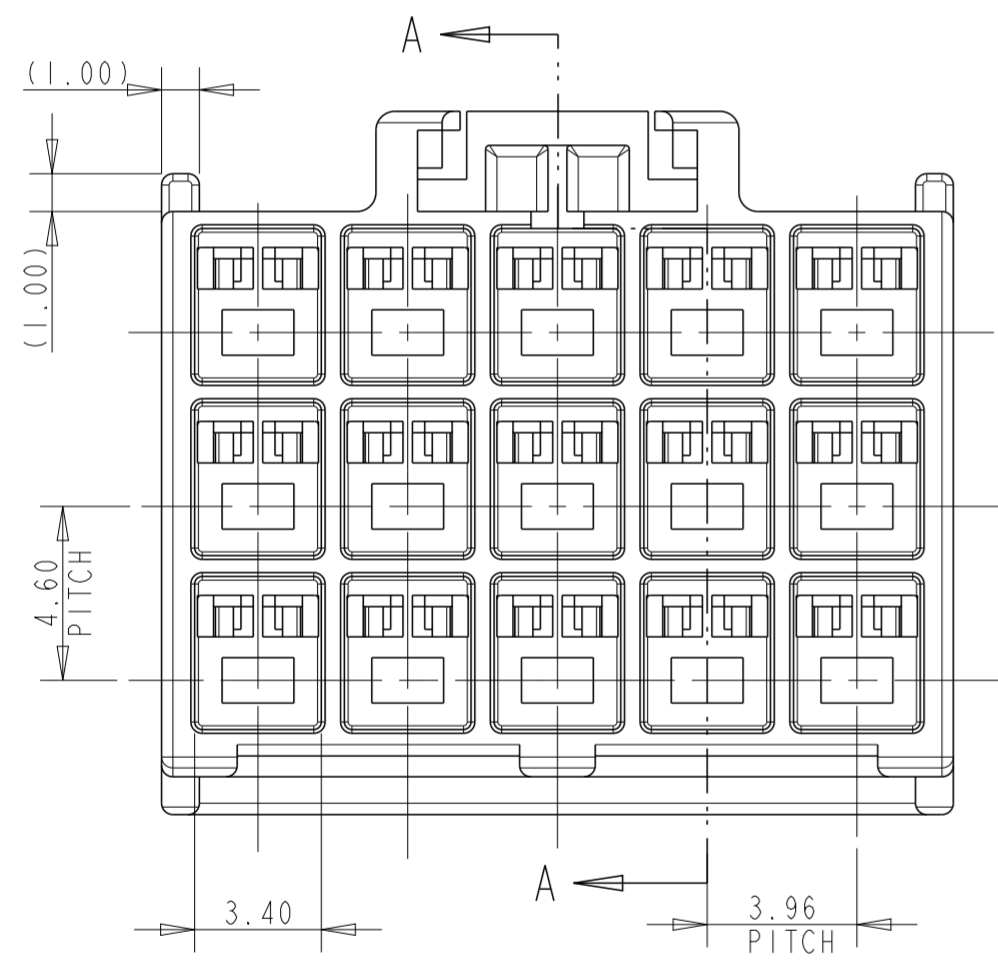

DISCONTINUED	HOUSING COLOR	POSITION	PART NUMBER
DEVELOPMENT	BLACK	15	176290-9
DEVELOPMENT	BLUE	15	176290-6
DEVELOPMENT	YELLOW	15	176290-4
DISCONTINUED	RED	15	176290-2
	NATURAL	15	176290-1

THIS DRAWING IS A CONTROLLED DOCUMENT.

DIMENSIONS: mm	TOLERANCES UNLESS OTHERWISE SPECIFIED:	DWN: M. SHINDO 23NOV1989	TE Connectivity NAME: AMP UNIVERSAL POWER CONN, 3.96mm PITCH CAP HOUSING 15 Pos (TPL ROW)
0 PLC ±	1 PLC ±0.25	CHK: M. YOSHIDA 28NOV1989	
2 PLC ±0.2	3 PLC ±	APVD: N. ONQUE 28NOV1989	
4 PLC ±	ANGLES ±3°	PRODUCT SPEC: 108-5302	
MATERIAL: 6/6 NYLON (UL94 V-0)	FINISH: -	APPLICATION SPEC: 114-5142	SIZE: A2
		WEIGHT: -	CAGE CODE: 00779
		CUSTOMER DRAWING	DRAWING NO: C-176290
			RESTRICTED TO: -
			SCALE: 5:1
			SHEET: 1 OF 1
			REV: B

REVISIONS					
P	LTR	DESCRIPTION	DATE	DWN	APVD
	C	REVISED PER ECR-20-100642	19SEP2022	M.G	D.Z

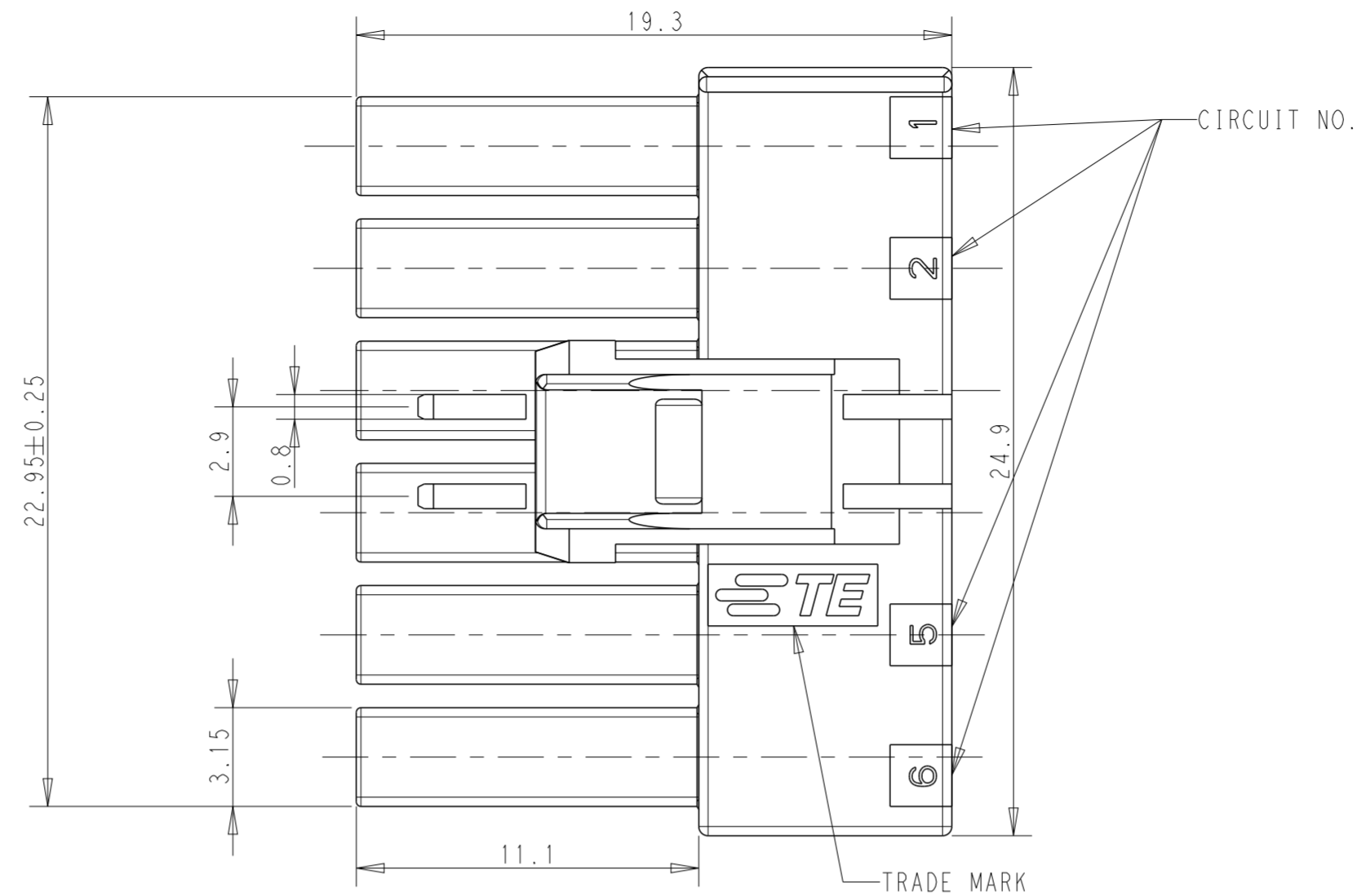

- 1 APPLICABLE CONTACT P/N:
 REC CONTACT: 175152- (20-16 AWG)
 175151- (26-22 AWG)
- 2 MATING CONN.P/N:
 CAP HSG: 176290- (FREE HANGING)
 176300- (PANEL MOUNT)
 TAB CONTACT: 175150- (20-16 AWG)
 175149- (26-22 AWG)
- 3 INSTRUCTION SHEET: IS-503J.

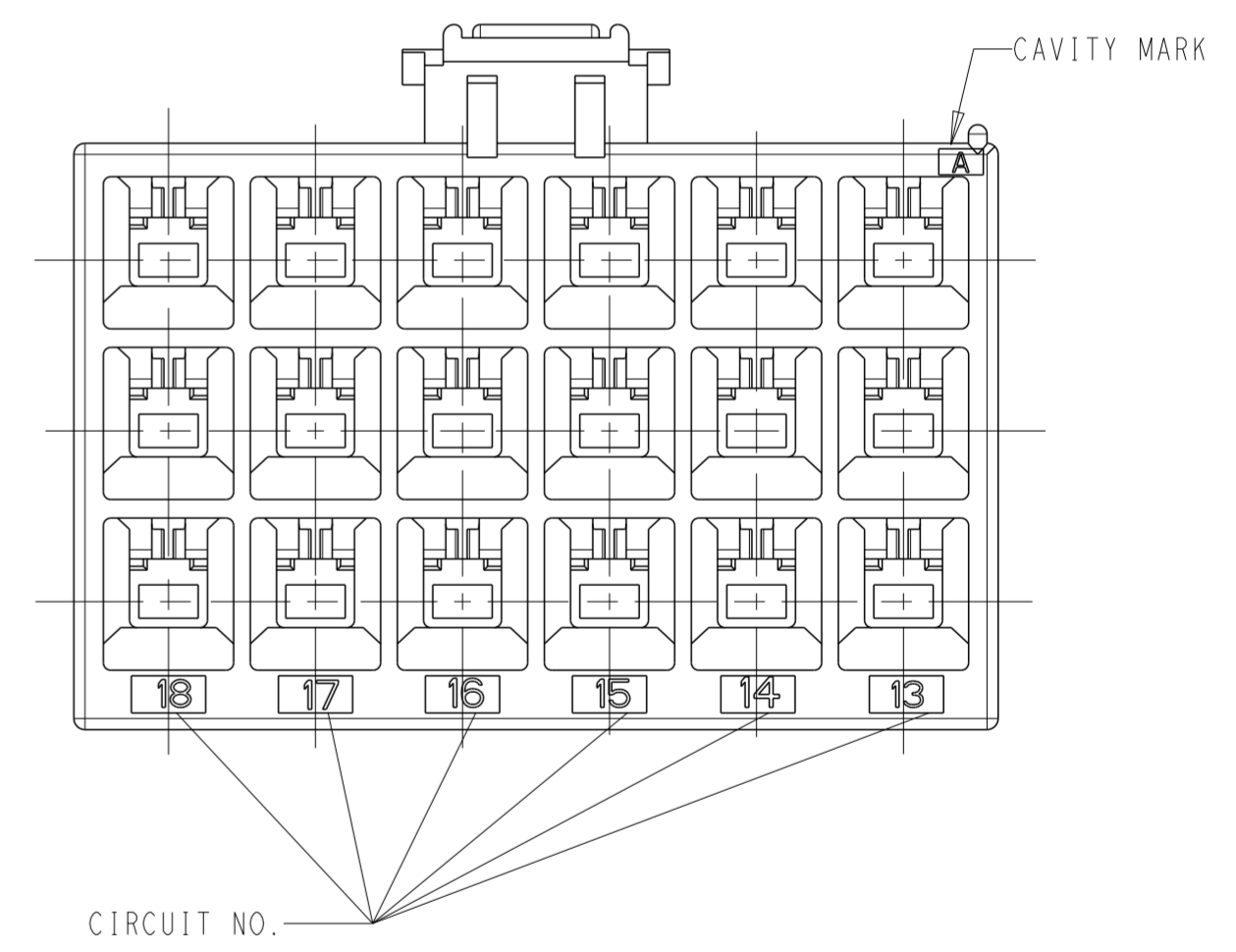
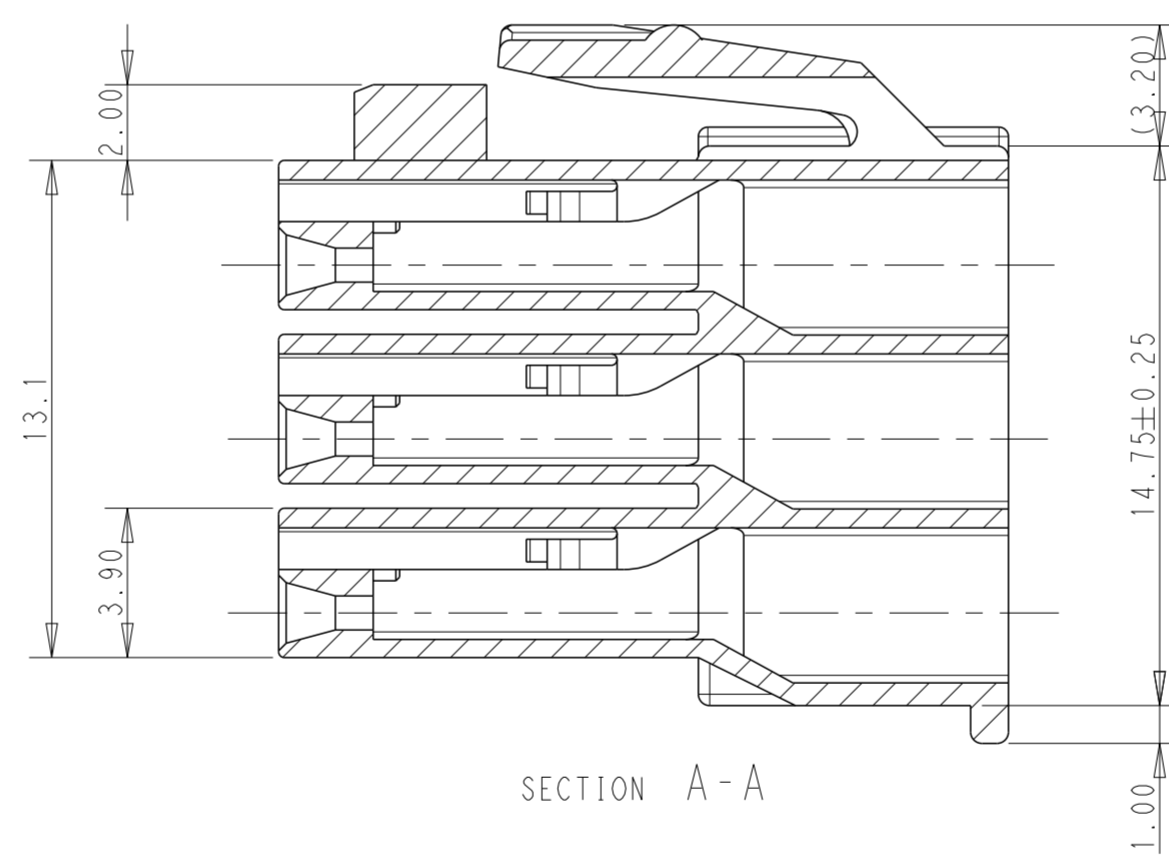
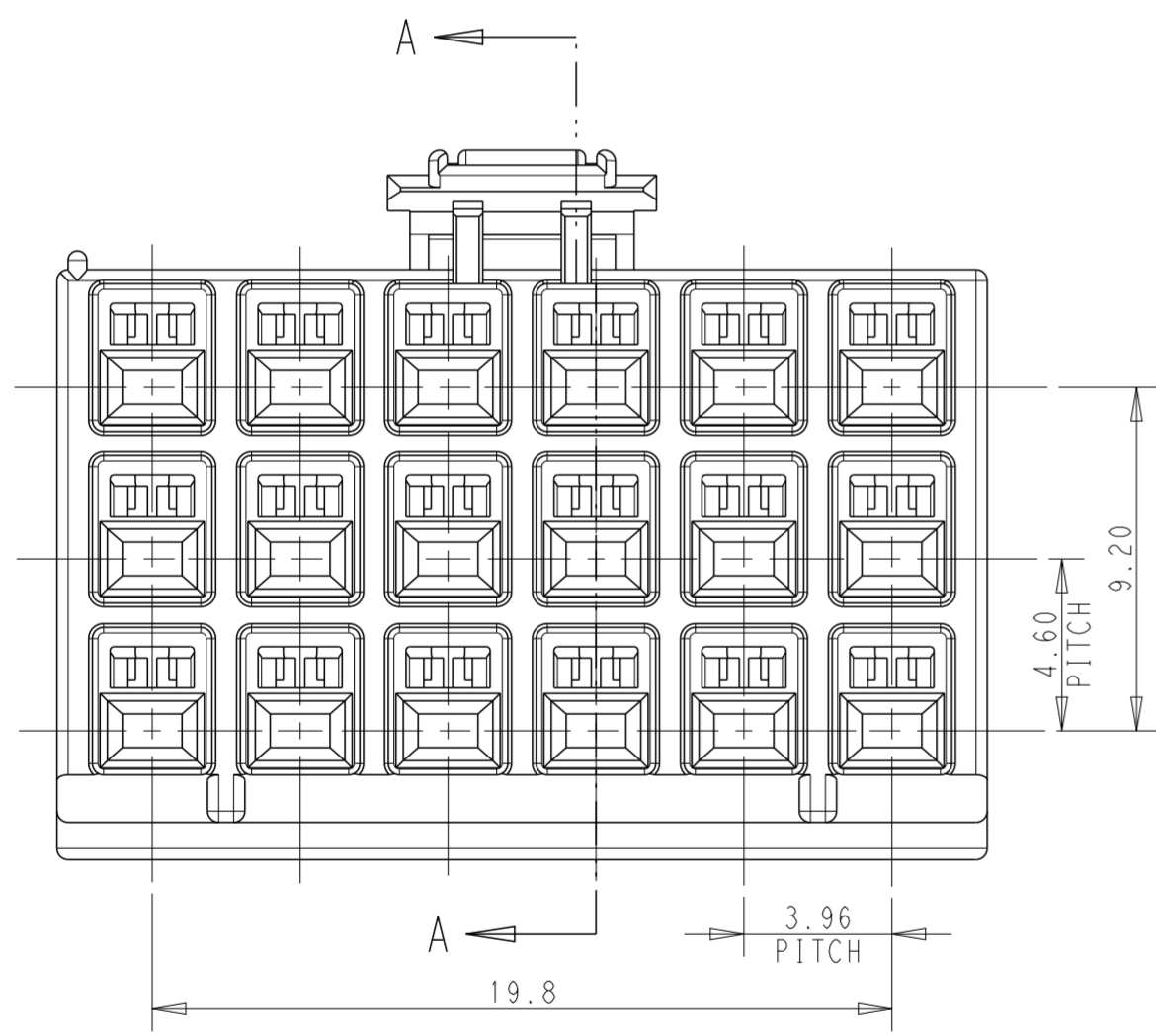

DEVELOPMENT	HOUSING COLOR	POSITION	PART NUMBER
	BLACK	18	176280-9
	BLUE	18	176280-6
	YELLOW	18	176280-4
	RED	18	176280-2
	NATURAL	18	176280-1

THIS DRAWING IS A CONTROLLED DOCUMENT.		DWN M. SHINDO 23NOV1989	STE TE Connectivity		
DIMENSIONS: mm		CHK Y. FUJITA 23NOV1989			
TOLERANCES UNLESS OTHERWISE SPECIFIED:		APVD N. ONOUE 23NOV1989	NAME AMP UNIVERSAL POWER CONN 3.96MM PITCH 18 POS PLUG HSG (TPL ROW)		
0 PLC ± 1 PLC ±0.25 2 PLC ±0.20 3 PLC ± 4 PLC ± ANGLES ±3° FINISH		PRODUCT SPEC 108-5302 APPLICATION SPEC 114-5142	SIZE A2	CAGE CODE 00779	DRAWING NO C-176280
MATERIAL NYLON 6/6 (UL94V-0)		WEIGHT -	RESTRICTED TO		
		RESTRICTED CUSTOMER	SCALE 5:1	SHEET 1 OF 1	REV C